

# Congratulations on buying the Mi3.5



This car is factory assembled to save you time, and ensure that all the parts fit together correctly. However please refer to the setup sheets at the back of the manual, as small adjustments may be required to setup the car for your individual driving style, and the type of track you race on.

This manual covers the Pro spec and the Race spec versions of the Mi3.5. The box end label will tell you which version you have.

Because this car is assembled, most of the manual will only be required for maintenance, Page 28 onwards deals with finishing the car assembly.

Additional items required.

2 Channel radio Control. Transmitter, Receiver and Steering servo.

Electronic Speed Controller.

Battery Pack. 7.2v NiMH, 6.0v NiMH or 7.4v Lipo.

Battery charger.

Motor and pinion.

Bodyshell and paint.

Wheels and tyres.

AA Batteries for transmitter.

Tools.

See back page of manual for some available option parts.

## Safety Notes

- This product is not suitable for children under 14 years of age unless supervised by an adult.
- Select an area for assembly that is away from the reach of small children. The parts are small and can be swallowed by children causing choking and possible internal injuries.
- Shock fluids, grease and adhesives should be kept out of childrens reach. They may be toxic and were not intended for human consumption.
- Exercise care when using hand tools, sharp instruments or power tools during assembly.
- Read the instructions fully and read all manufacturers warnings and cautions for any additional items that may be used for assembly purposes.
- Always drive your car safely and away from public roads, and be aware of any people or animals near you. **MODEL CARS CAN BE DANGEROUS.**
- Learn to use your power with respect, very few surfaces can cope with full power. If you use full power everywhere you WILL break things.
- Always ensure that the transmitter batteries are fully charged.
- Always ensure that all nuts and screws are tight and the gear mesh is correct.
- Superglue the tyres to the wheels as they may come off at high speeds.
- This product is not a toy, it is a hobby product capable of high performance, but it will require regular maintenance. Learn to drive the car slowly at first, away from solid objects.
- The carbon fibre chassis conducts electricity, beware of short circuiting the batteries.

# IMPORTANT

Please read the entire manual before starting the assembly of your new MI-3.5

Before you start Building your car checkout the setup Sheets at the end of the manual or online at [www.racing-cars.com](http://www.racing-cars.com) to ensure the car is built to suit your driving style and track conditions



## Rear Diff Assembly

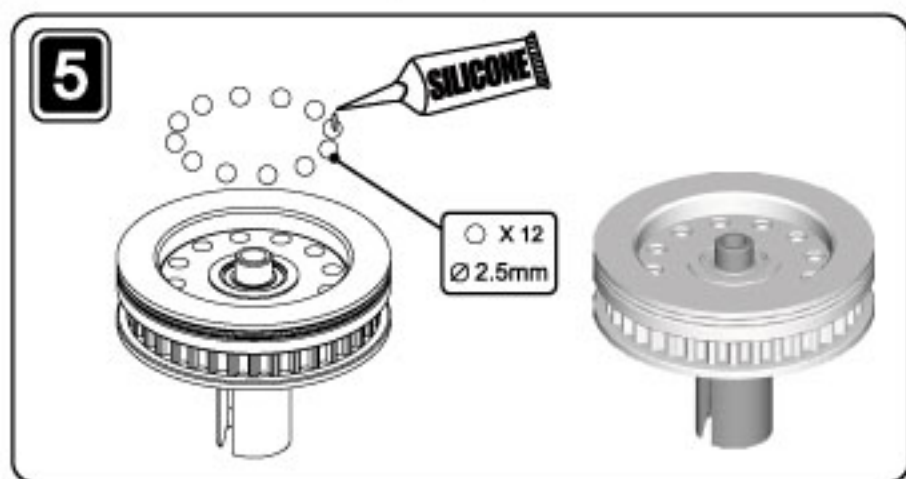
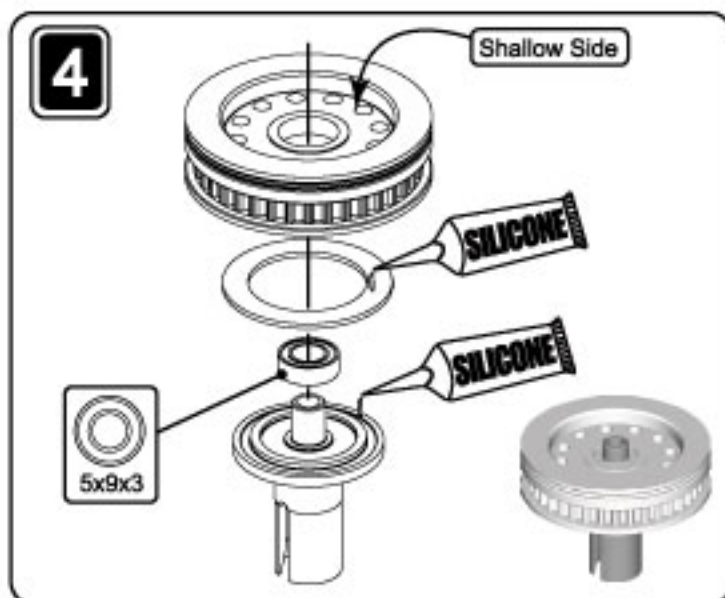
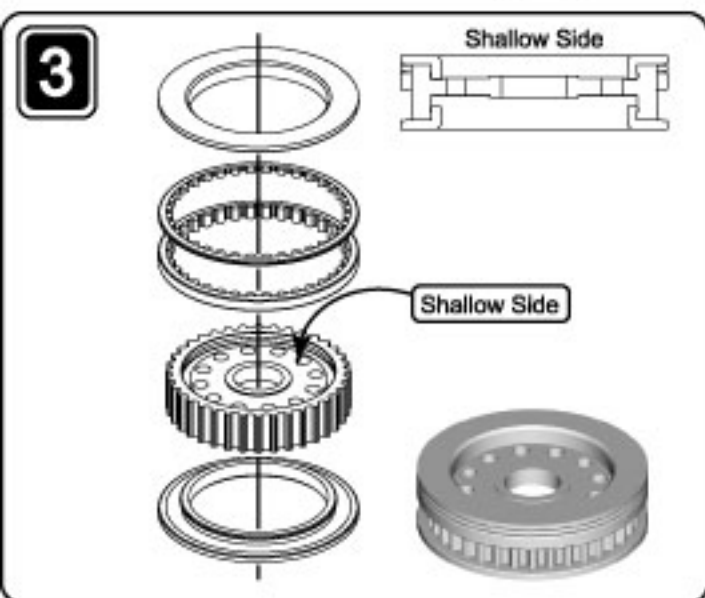
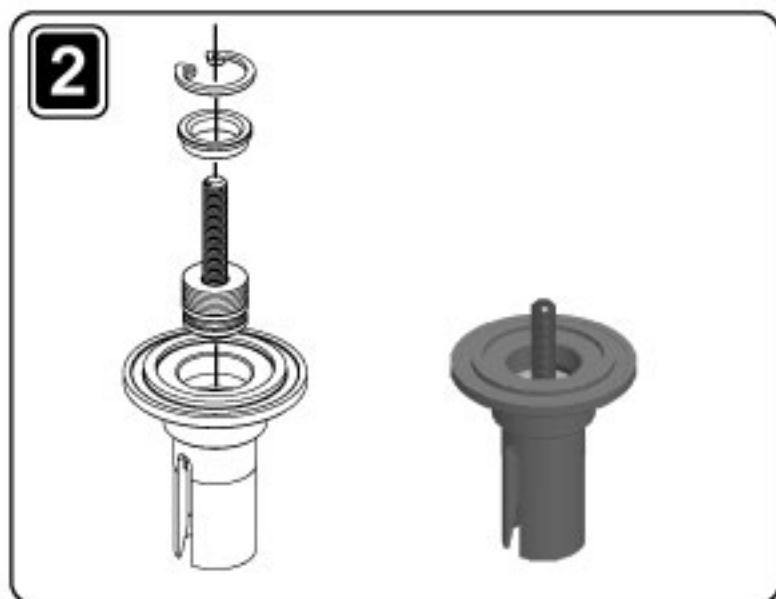
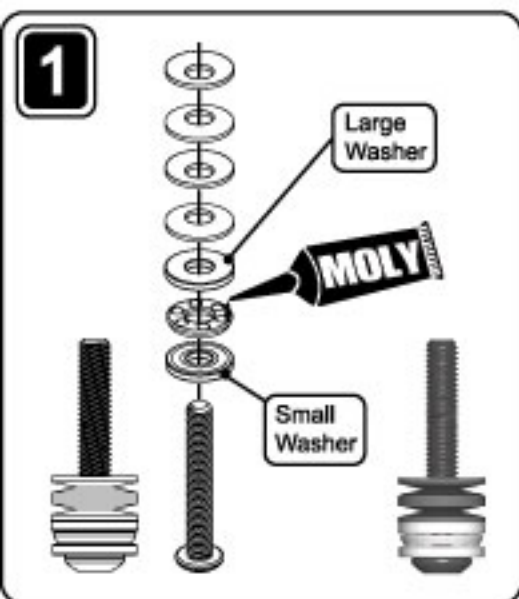

6

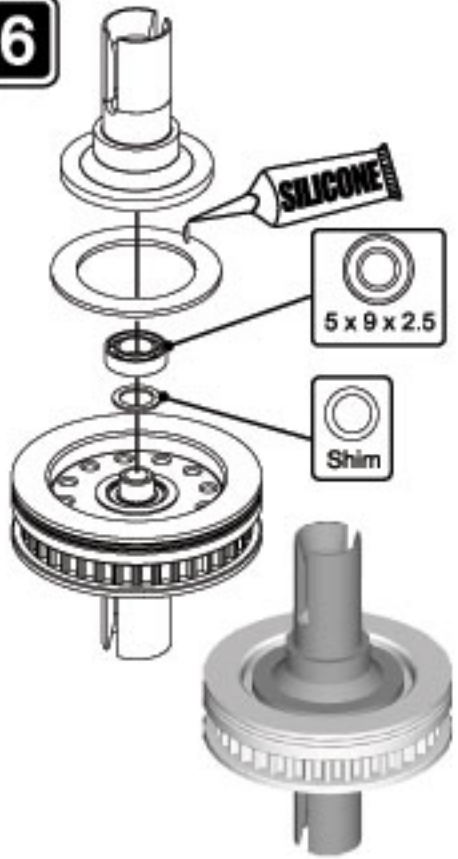

7



**Diff Assembly cont..**

8

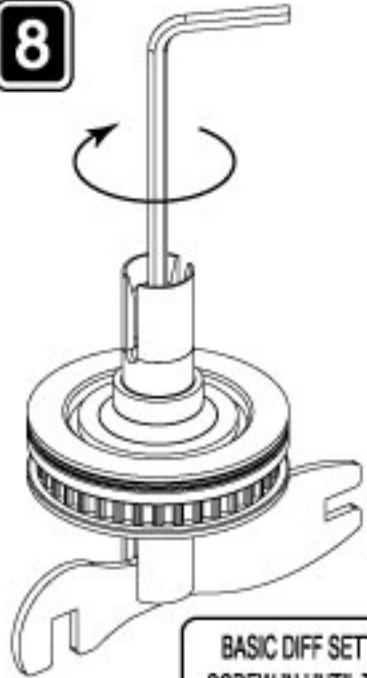

BASIC DIFF SETTING  
SCREW IN UNTIL TIGHT  
(ALL DISC SPRINGS FLAT)  
THEN UNDO 270°  
(3/4 TURN)

9

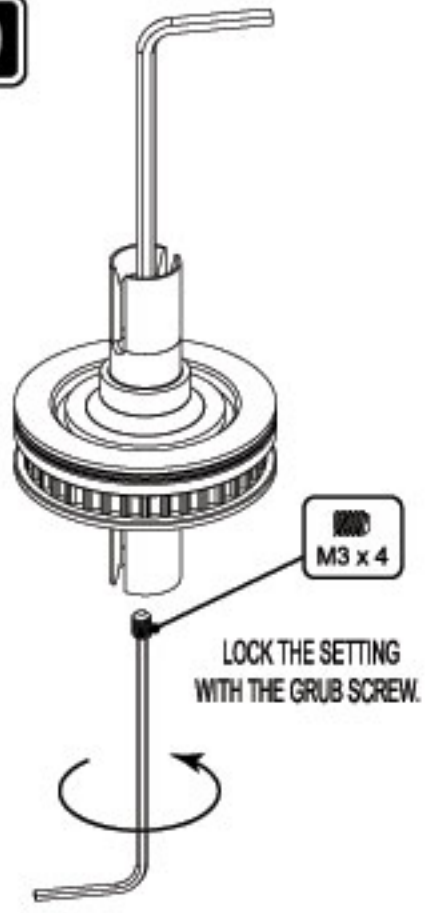

10



**Final Assembly**





# Spool Assembly

1

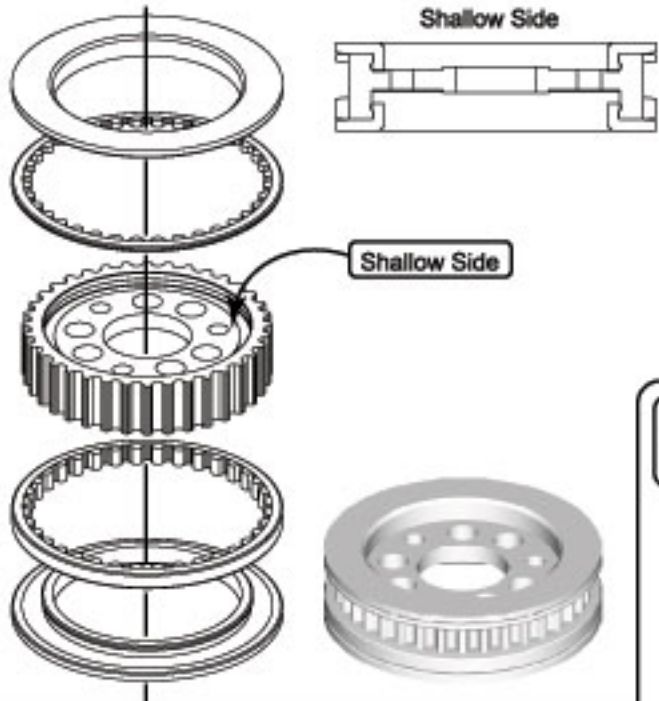

2

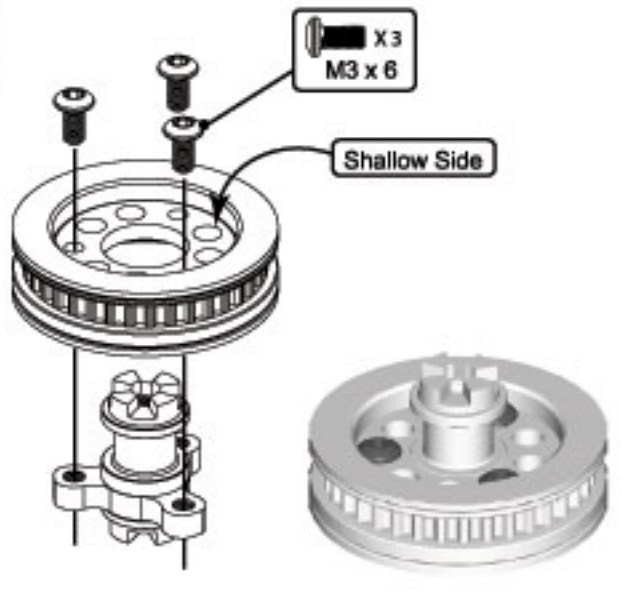

3

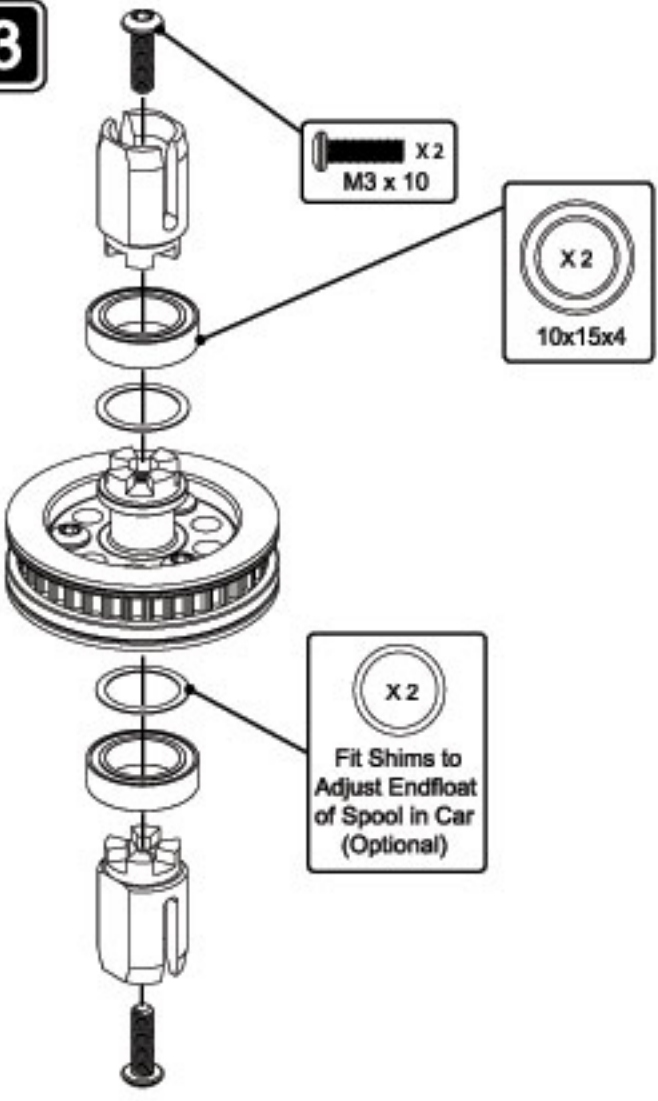

## Final Assembly

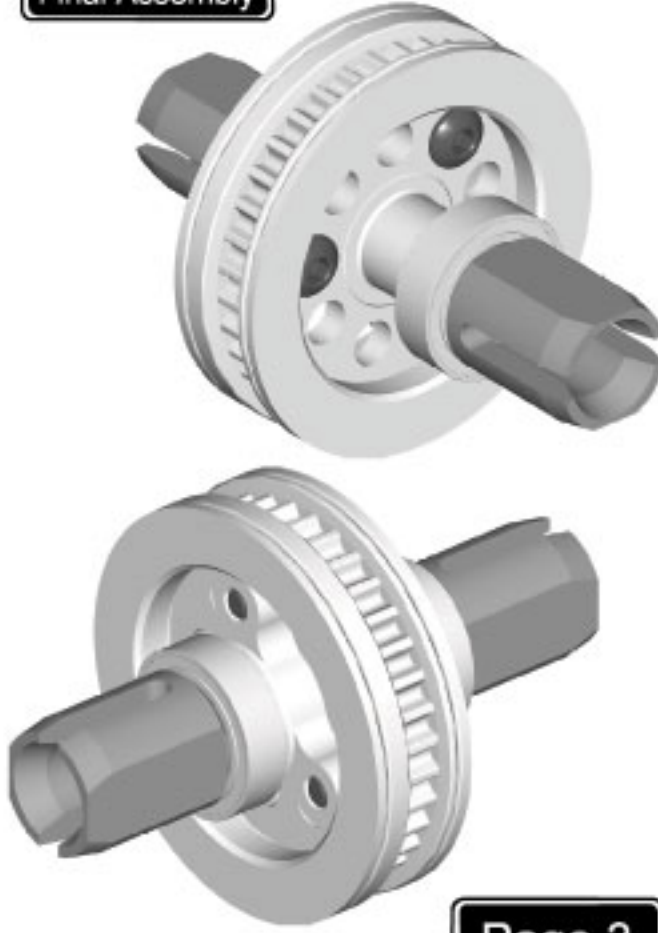



## Shock Assembly Pro-Spec

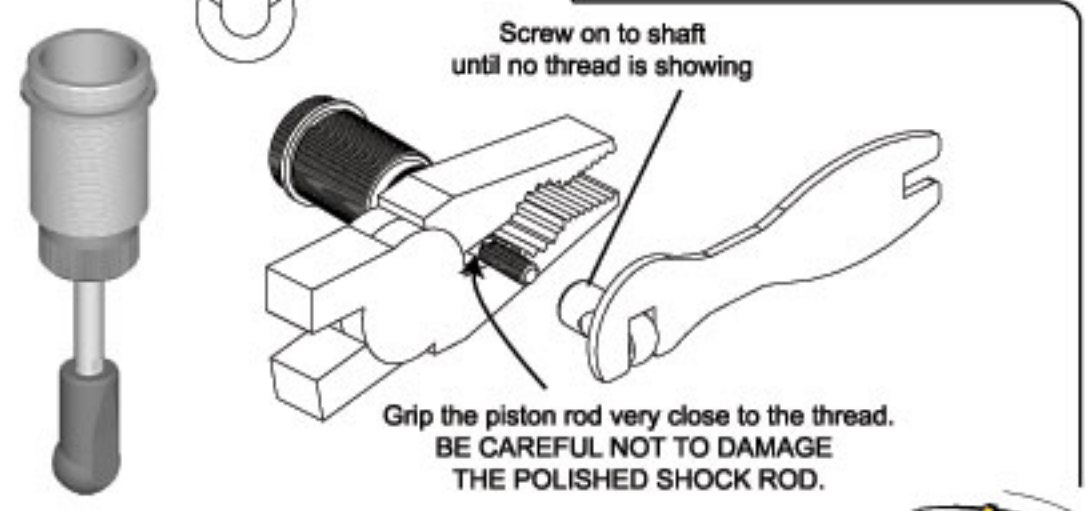
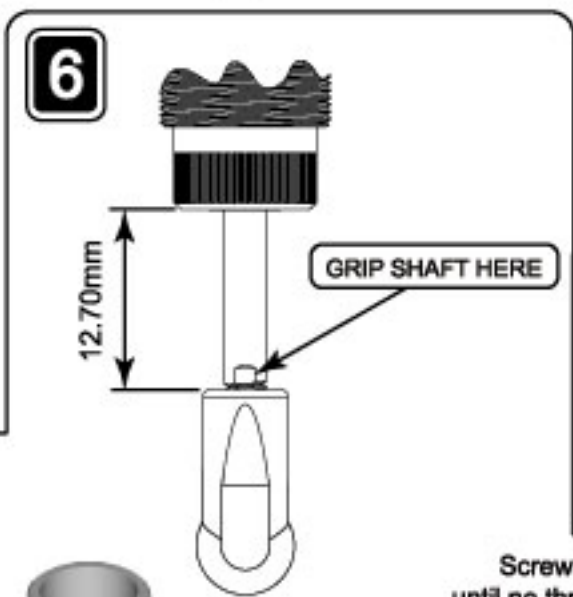
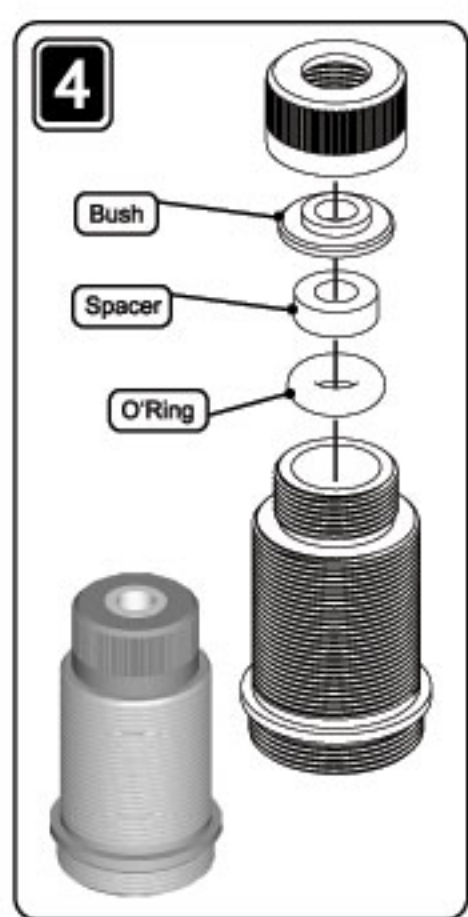

**6**

Fill Slowly With Shock Oil until Domed. Move Piston Up and Down Slowly and Allow all Air Bubbles to Rise and disappear.

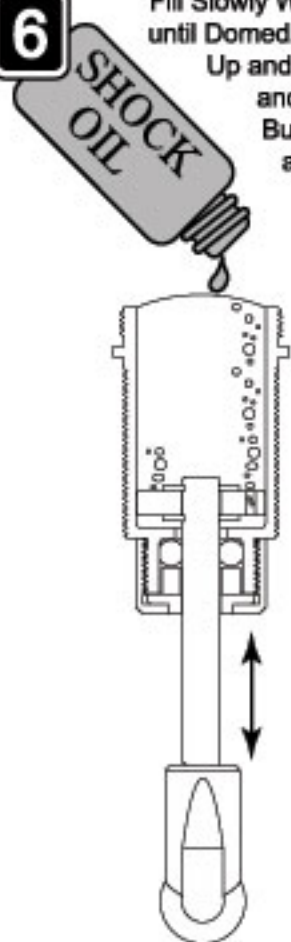
**7**

Shock Assembly cont..  
Pro-Spec

**9**

Lubricate the Threads with a SMALL amount of shock oil

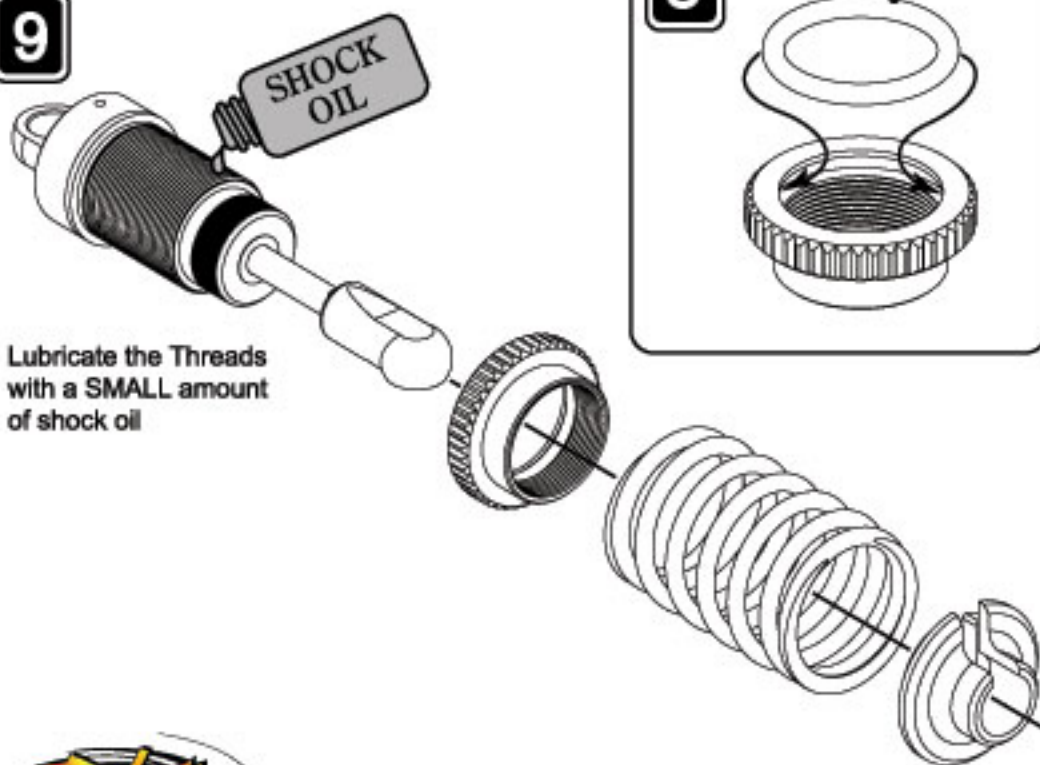
**8**

O'Ring



Final Assembly

61.30mm (All 4 Shocks the Same)



## Shock Assembly Race-Spec

1



2



3



4



5

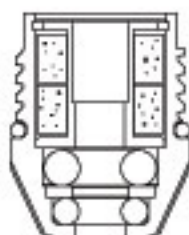
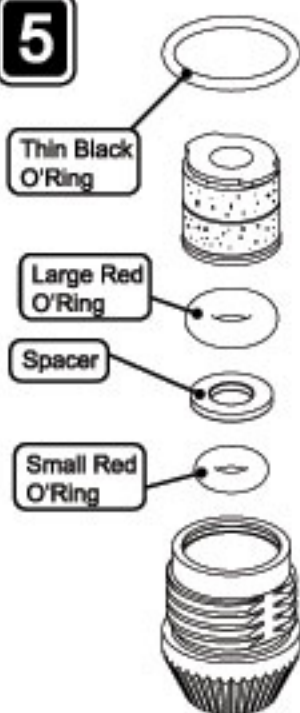

6

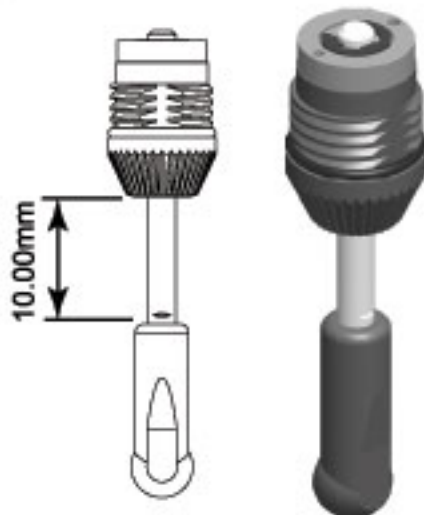

7



Grip the piston rod very close to the thread.  
BE CAREFUL NOT TO DAMAGE  
THE POLISHED SHOCK ROD.

6 Fill Slowly With Shock Oil to the bottom of the thread.

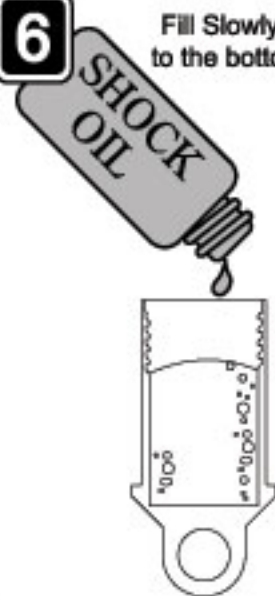

## Shock Assembly cont.. Race-Spec



9

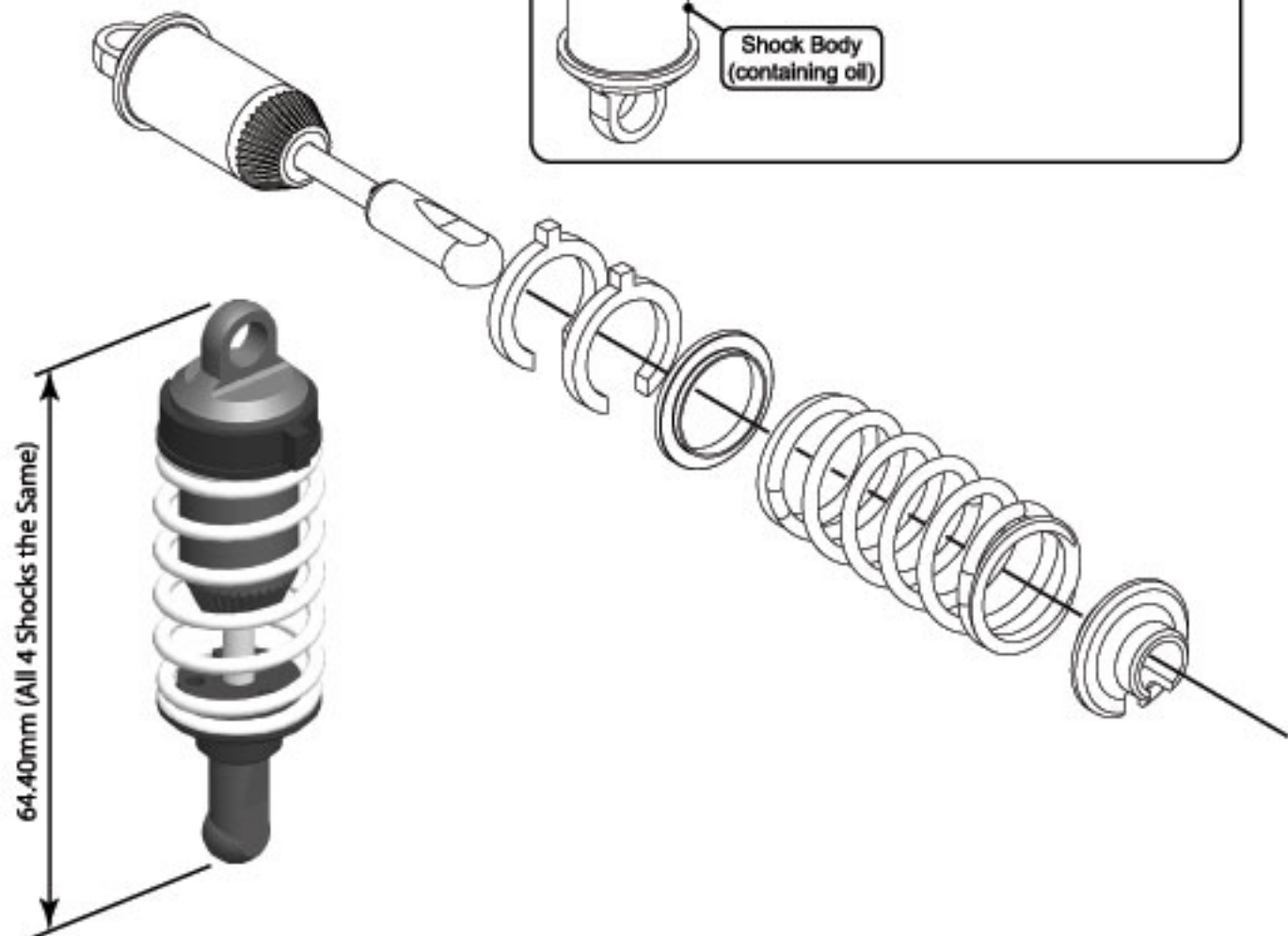

64.40mm (All 4 Shocks the Same)





1



Stage 1

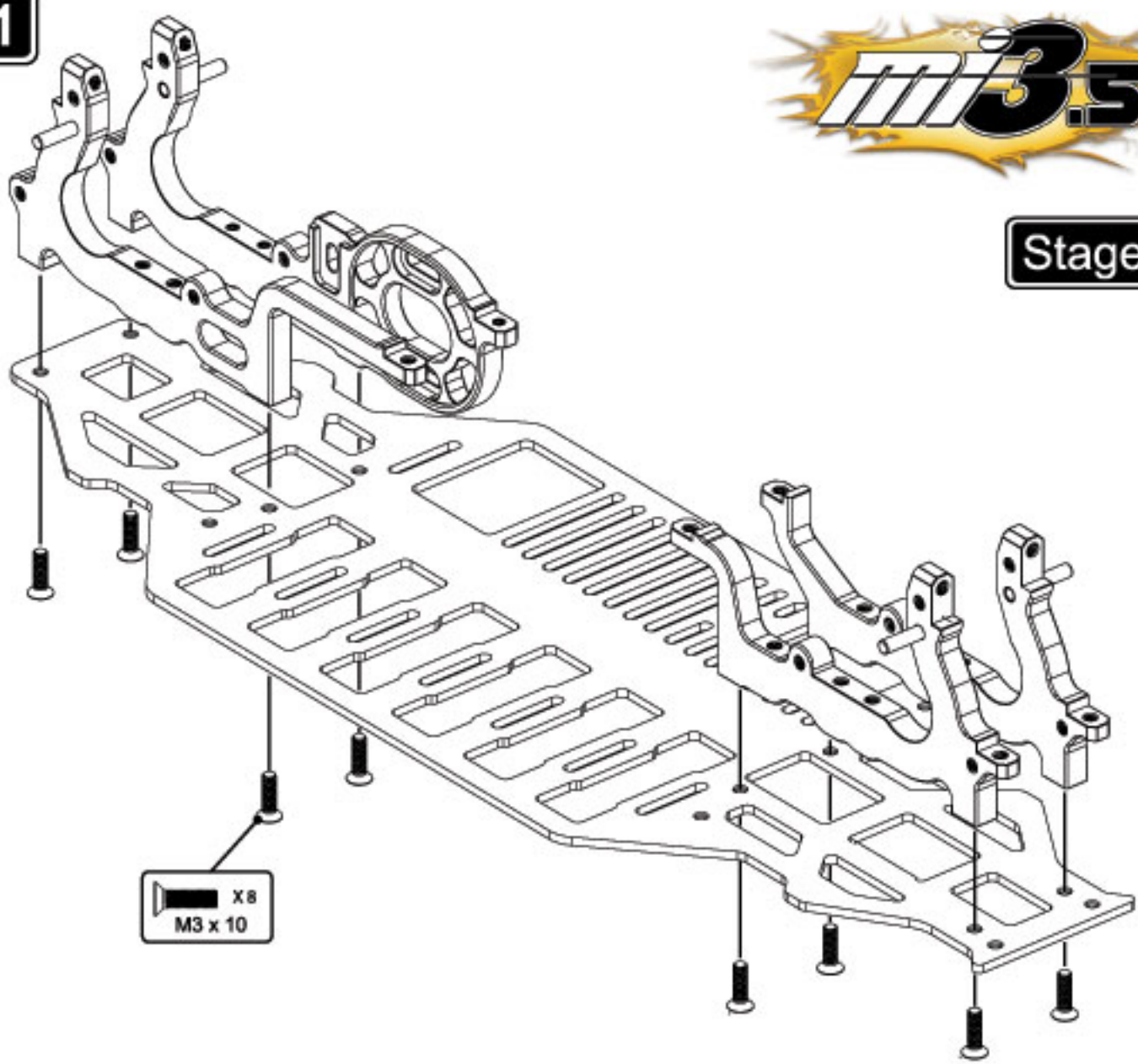

X8  
M3 x 10

Final Assembly

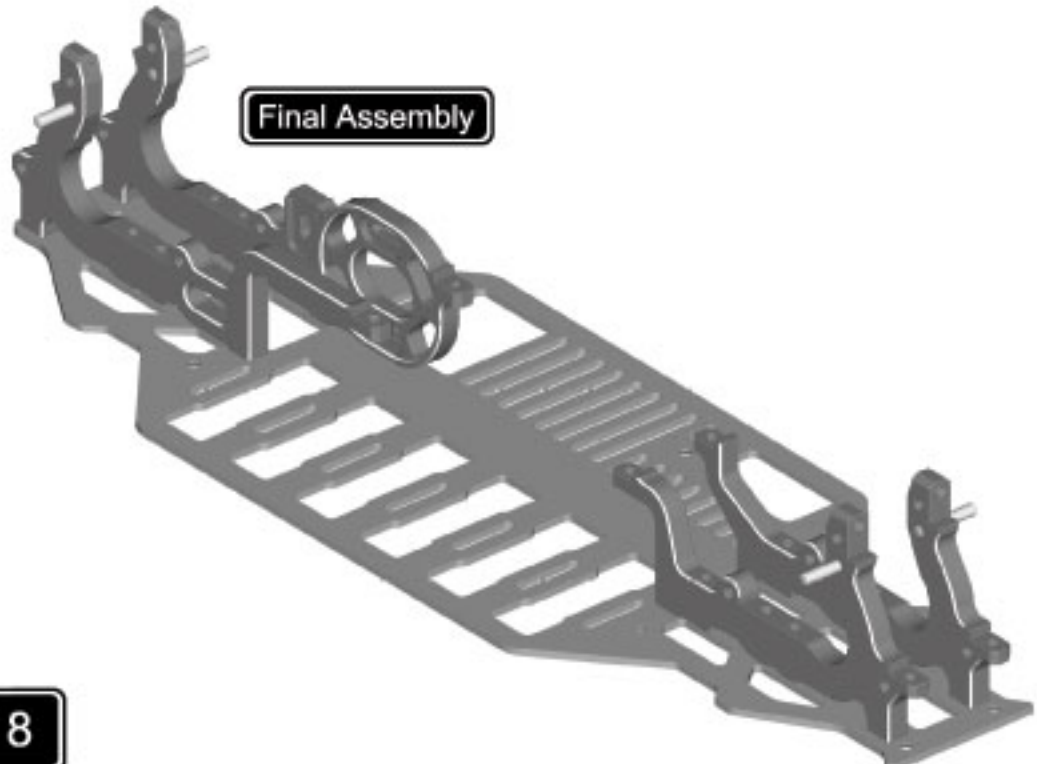

www.racing-cars.com

Page 8

1

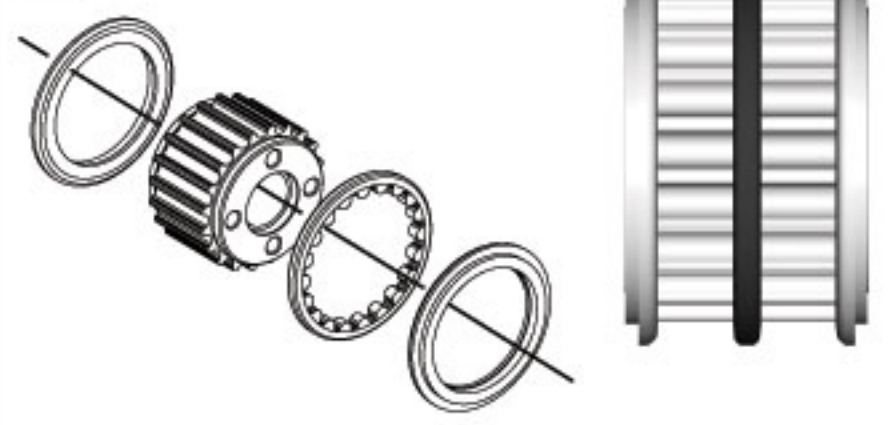

2

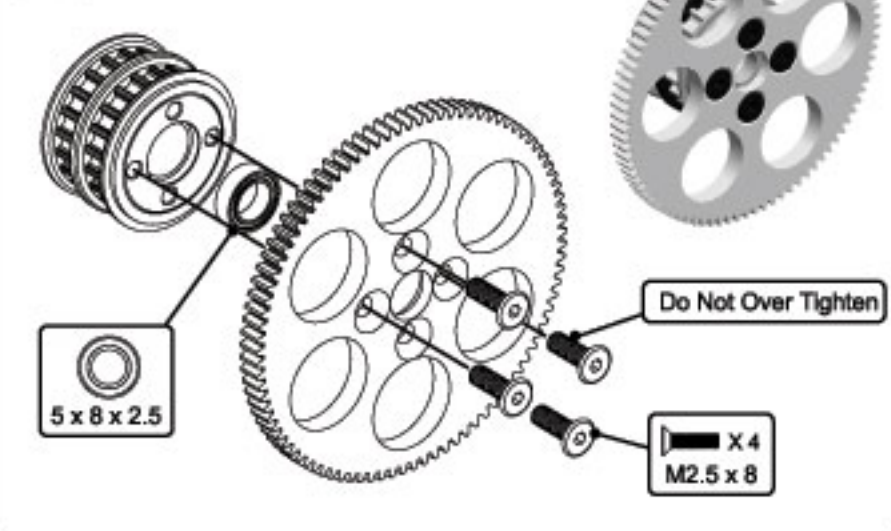

3

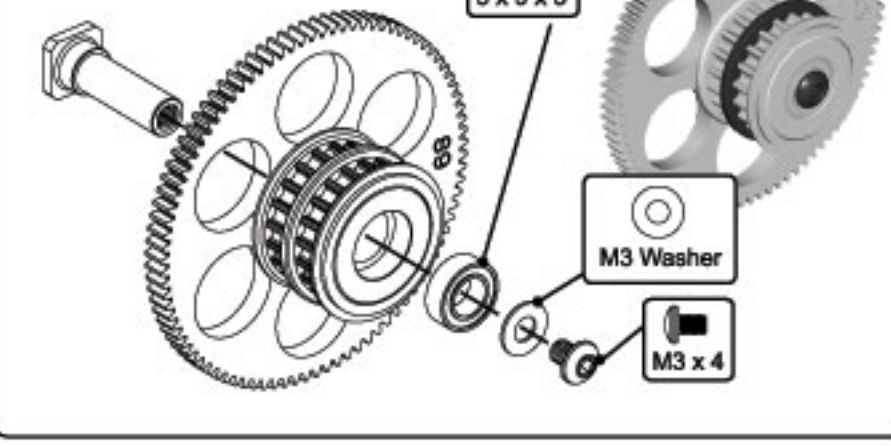

4



Stage 2 cont..

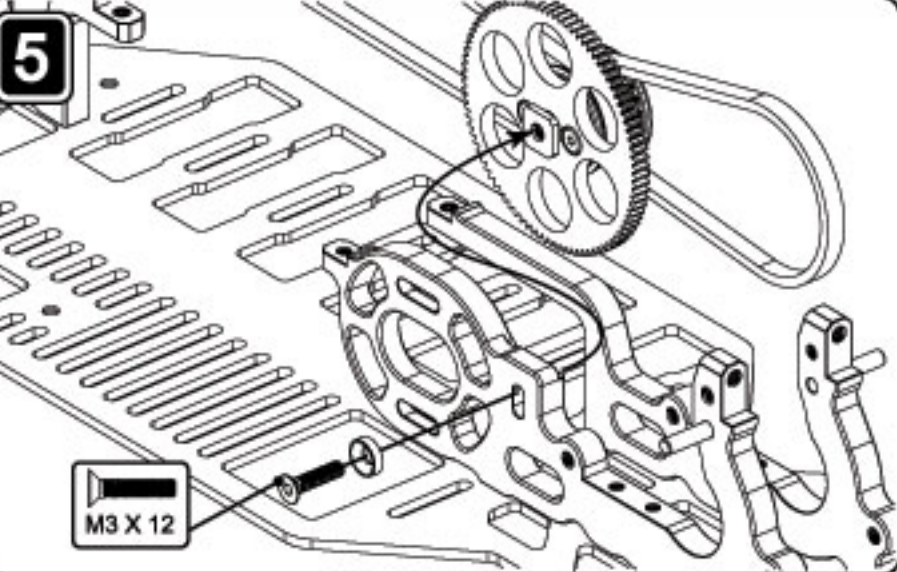
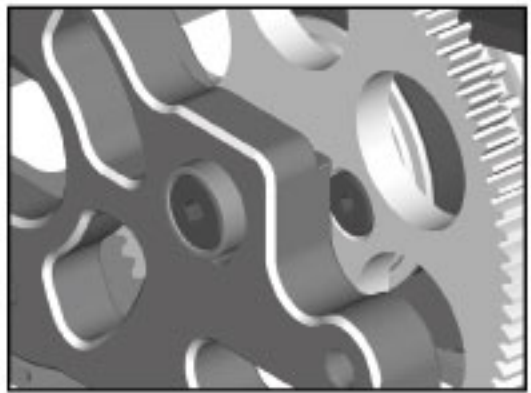

**SPUR GEAR HEIGHT**

The height of the spur gear may be adjusted depending on the size of gear you are using. It should be set so that the gear is just above the bottom of the chassis.

Final Assembly

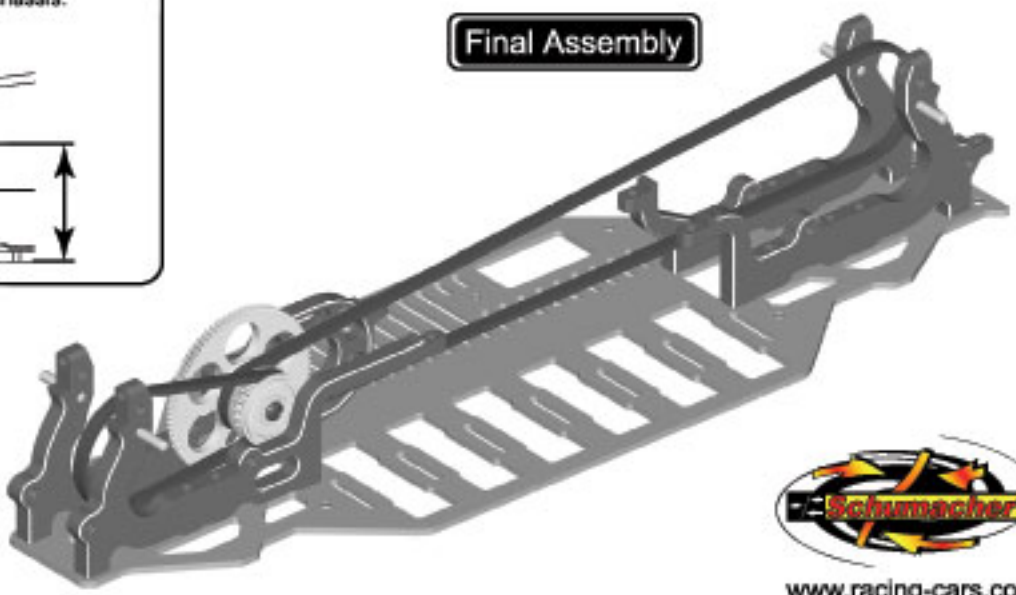

**1** Fit Shims to Adjust Endfloat of Diff in Car (Optional) **X2**

**X2**  
10 x 15 x 4

High Low

Set the Spool and Diff the Same

The Indents Must Face Outwards

**Stage 3**

**2**

5.50 mm

5.50mm

Nitrile X4 Damper

**3** Nitrile Damper

Optional

**4**

M3 x 20 X 2

REAR

MAKE SURE BOTH CAMS ARE SET THE SAME

**5**

The Indents Must Face Outwards

**6**

M3 x 20 X 2

FRONT

MAKE SURE BOTH CAMS ARE SET THE SAME

**Final Assembly**

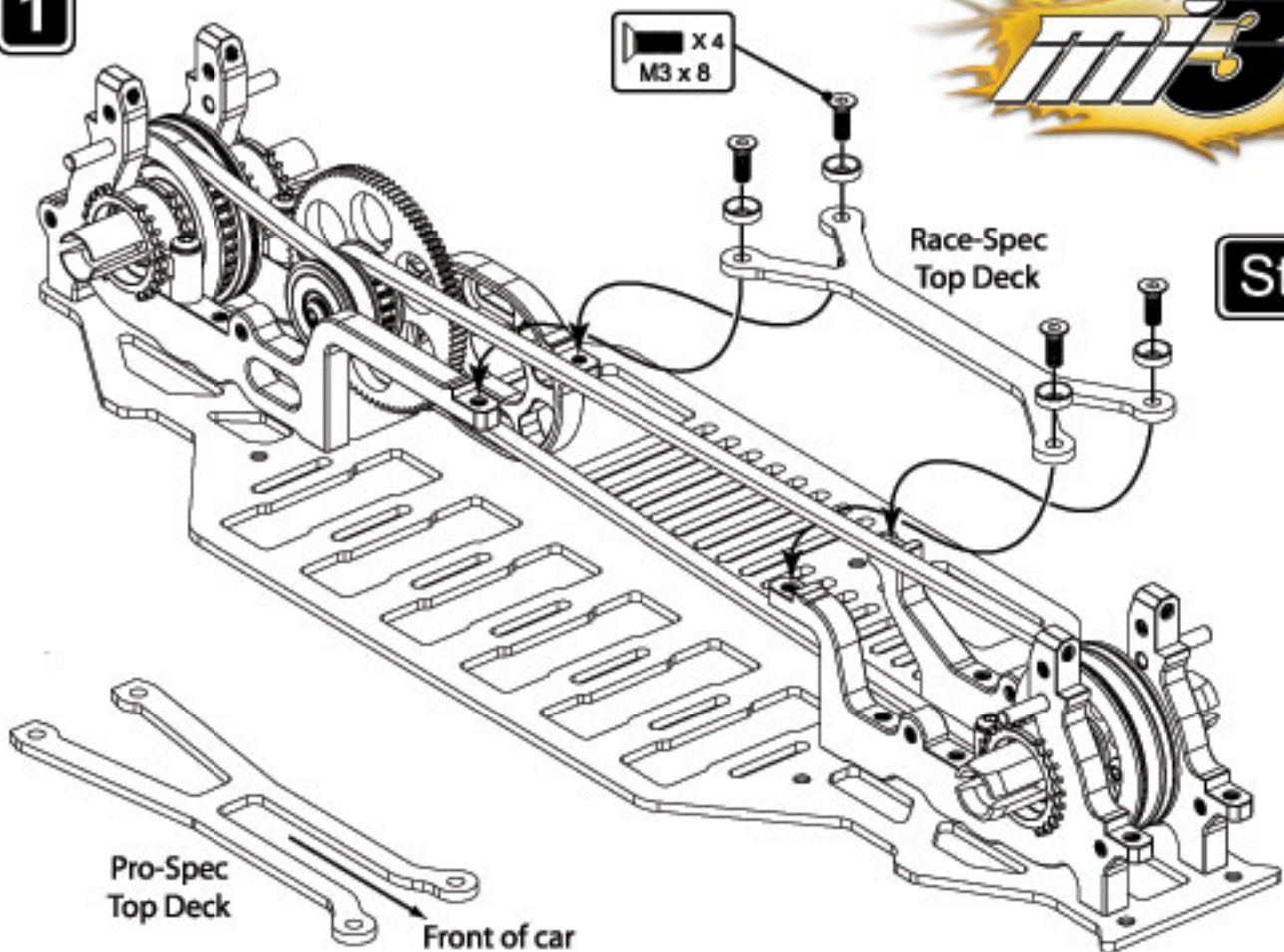
**1****Stage 4****BELT TENSION****BELT TENSION**

Rotating the Diff Cam towards the layshaft will decrease the belt tension, and rotating it away will increase the tension.

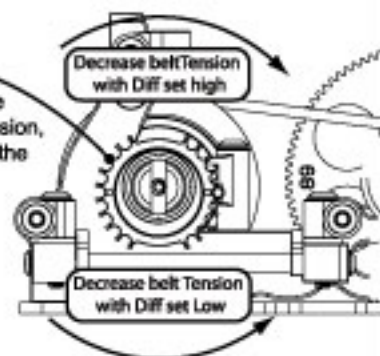
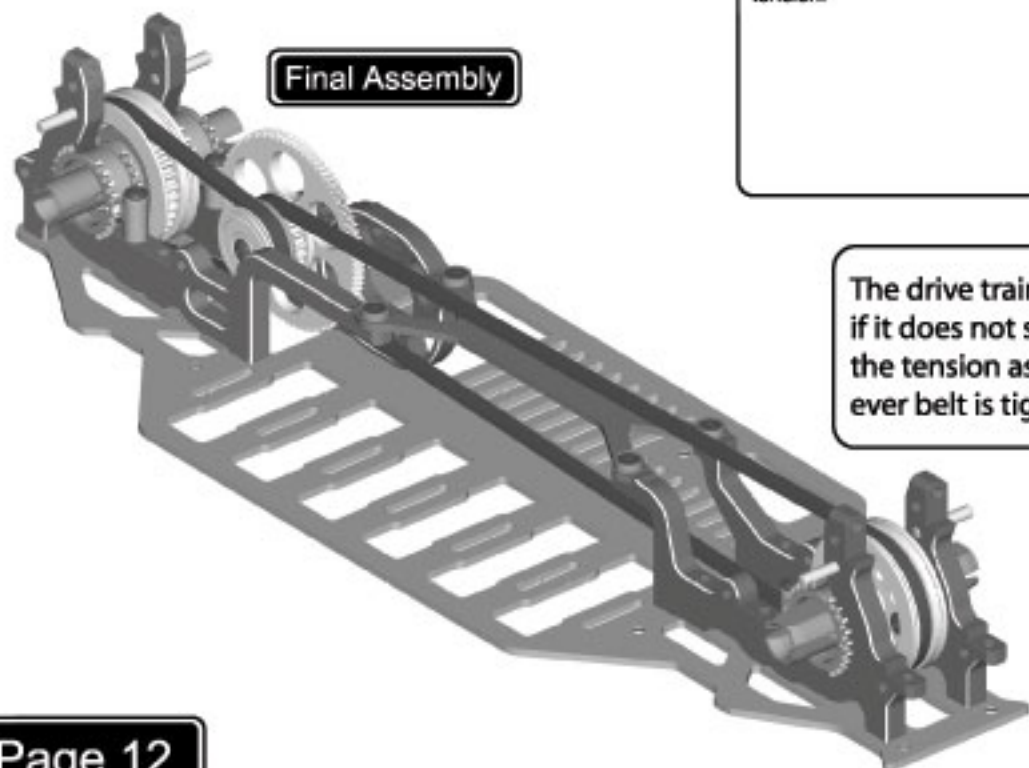
**Final Assembly**

The drive train should now spin freely, if it does not spin freely then decrease the tension as shown above on which ever belt is tight.



# Rear Suspension Right hand Side

## Stage 5

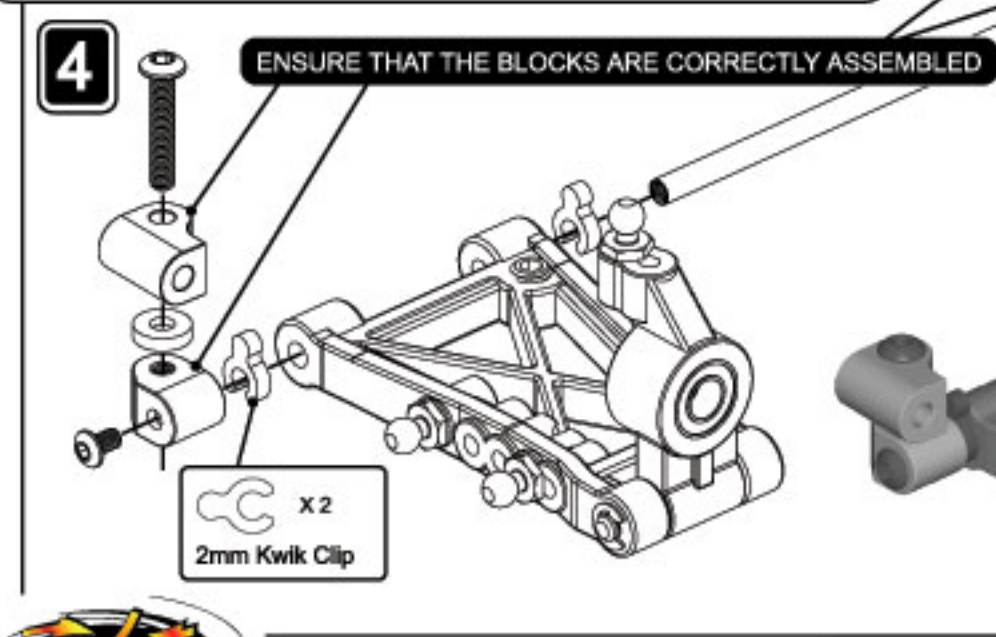
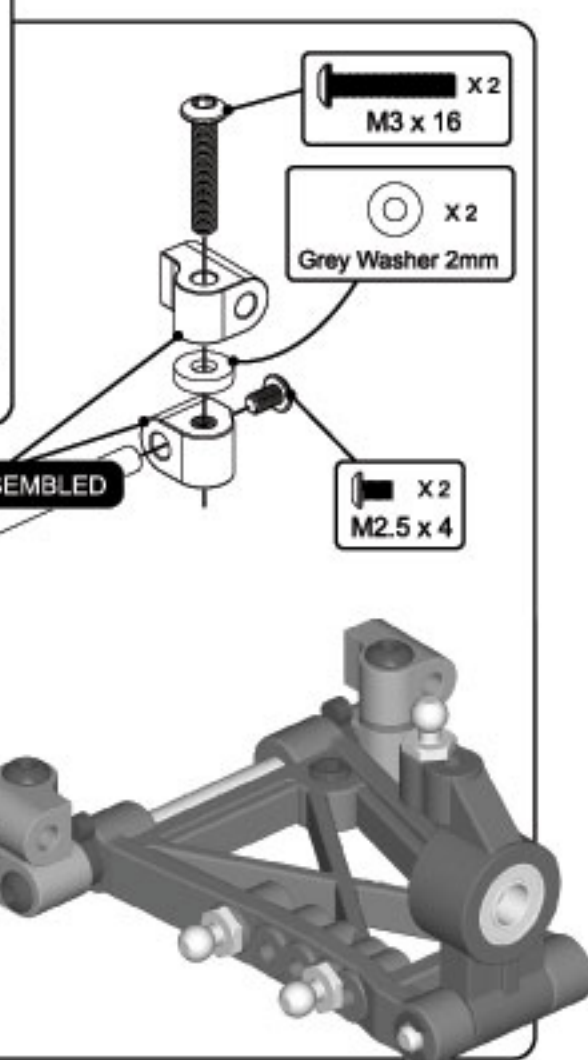
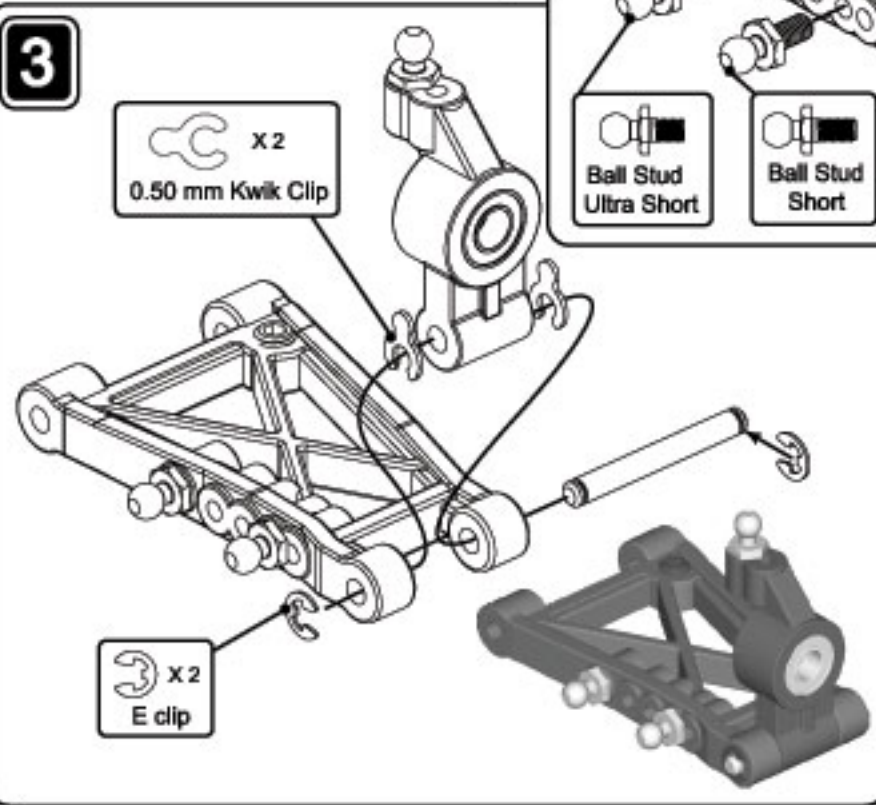
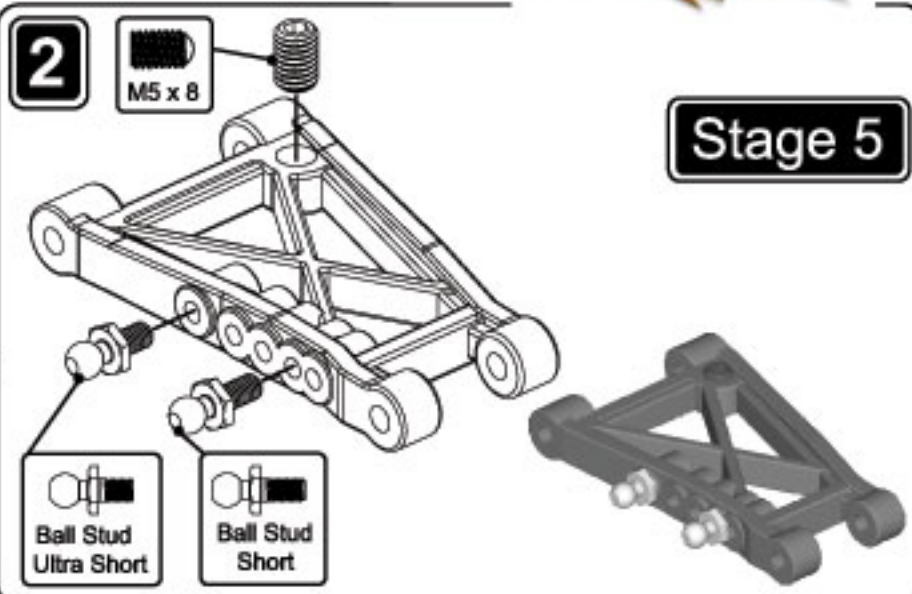
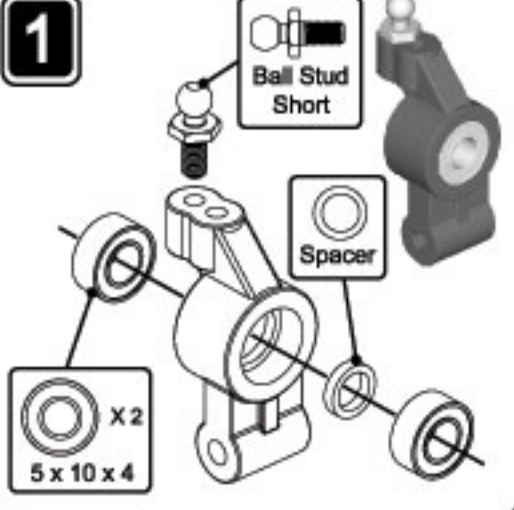



Stage 5 cont..

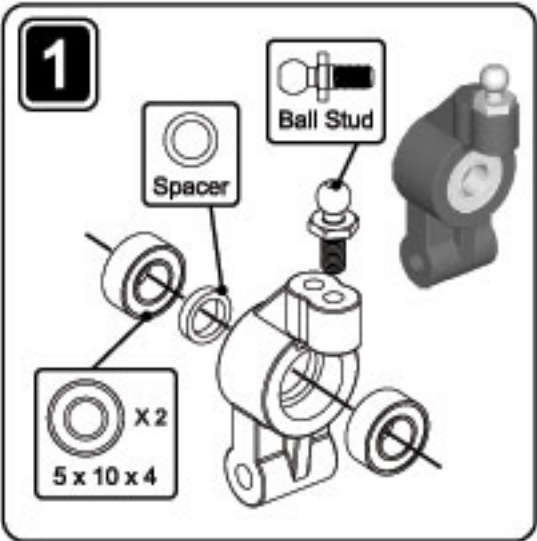
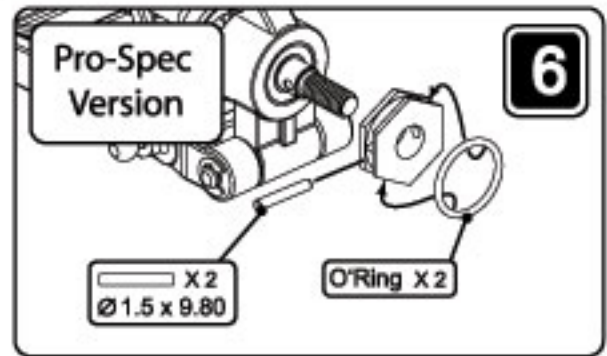
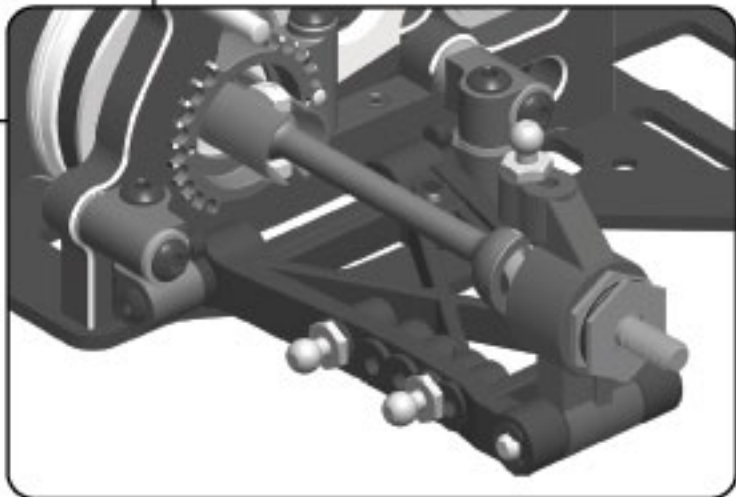
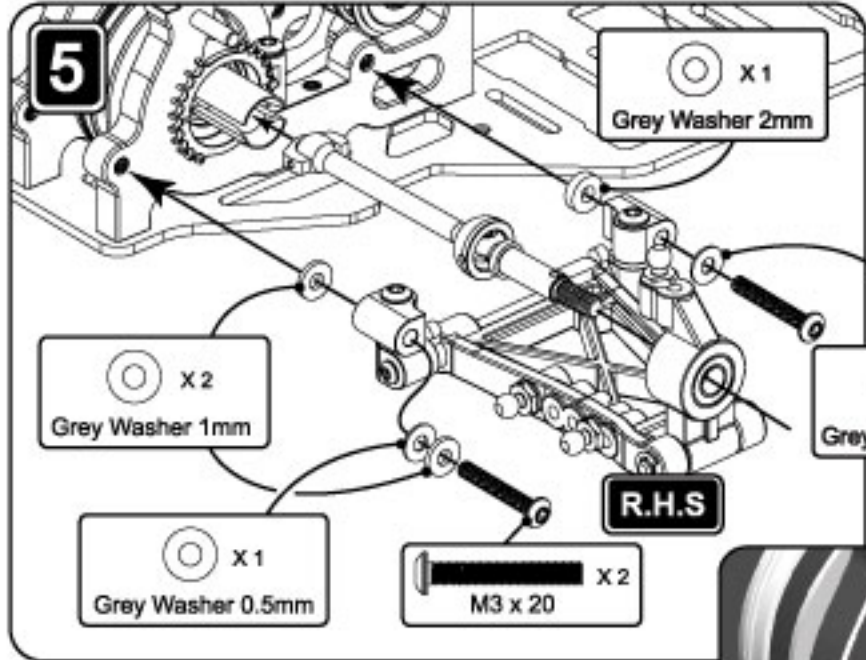

Rear Suspension Left hand Side

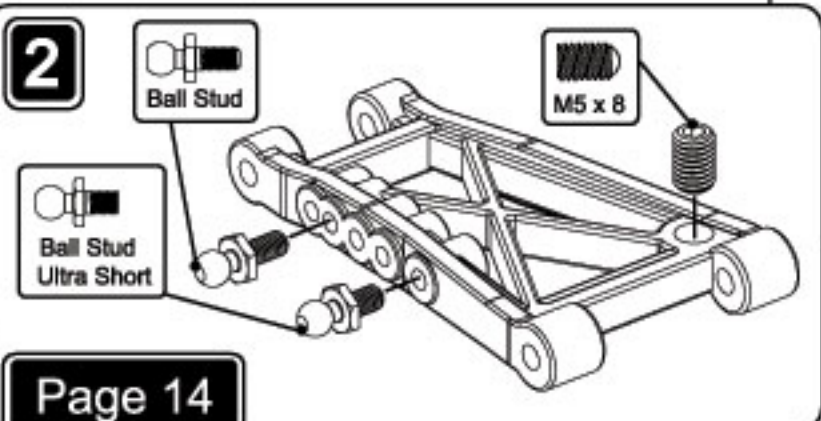
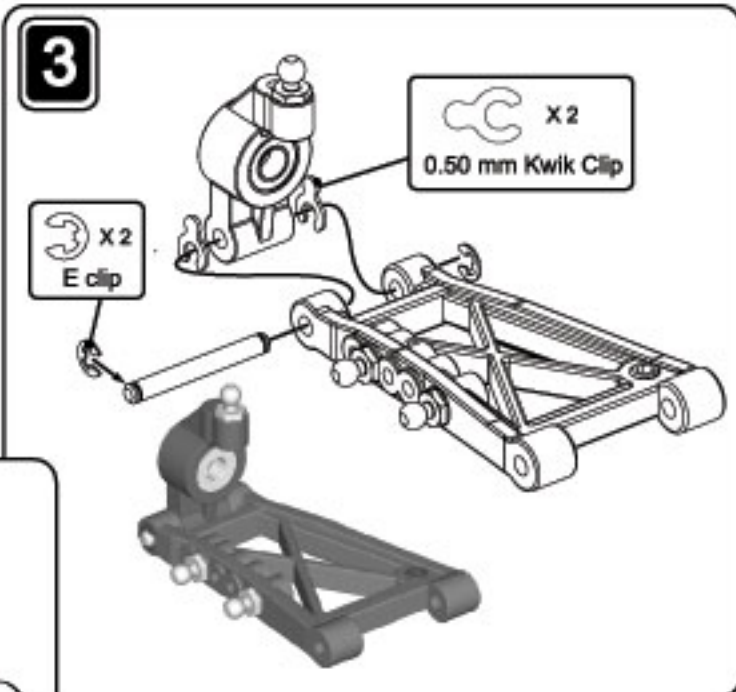

4

ENSURE THAT THE BLOCKS ARE CORRECTLY ASSEMBLED

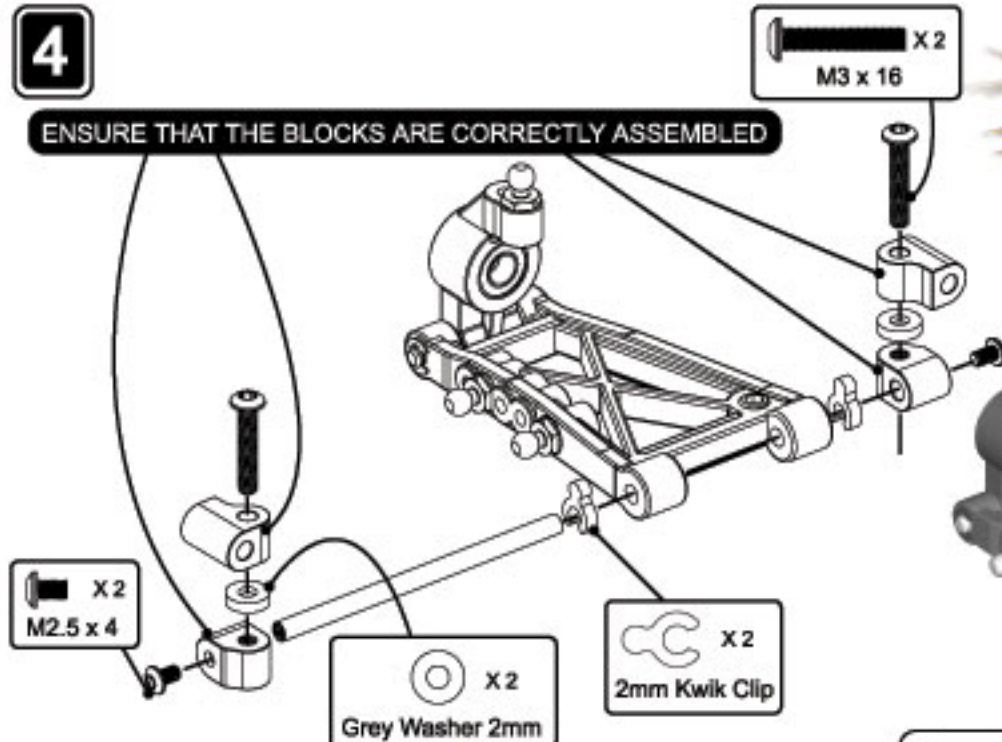

Stage 5 cont..

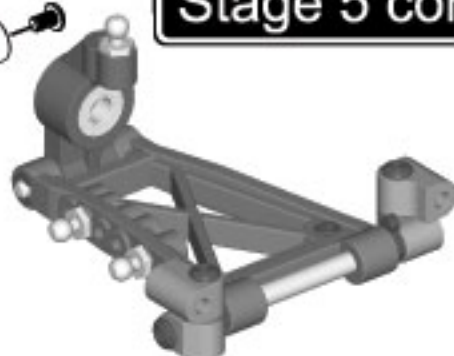

5

M3 x 20 X2

Grey Washer 0.5mm X1

Grey Washer 2mm X1

Grey Washer 1mm X2

Grey Washer 0.5mm X1

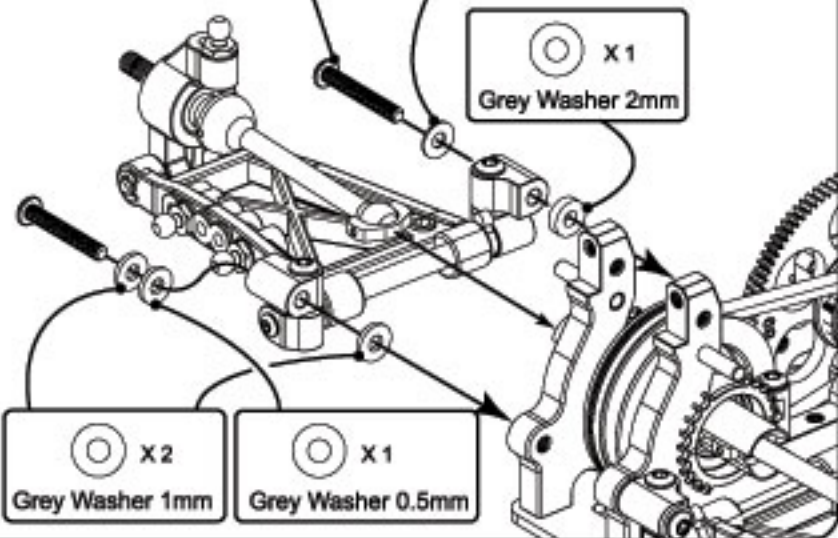

6

Pro-Spec Version

O'Ring X2

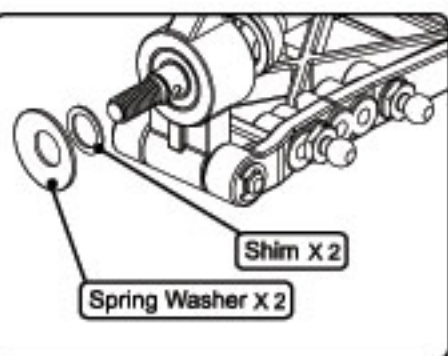
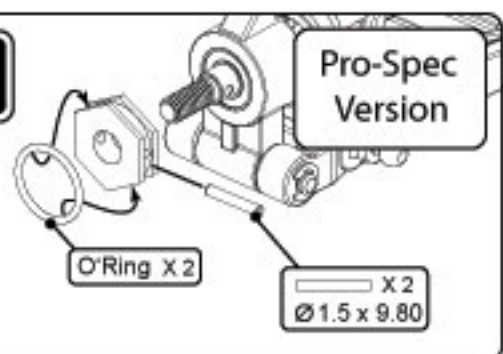
X2  
Ø 1.5 x 9.80

Race-Spec Version

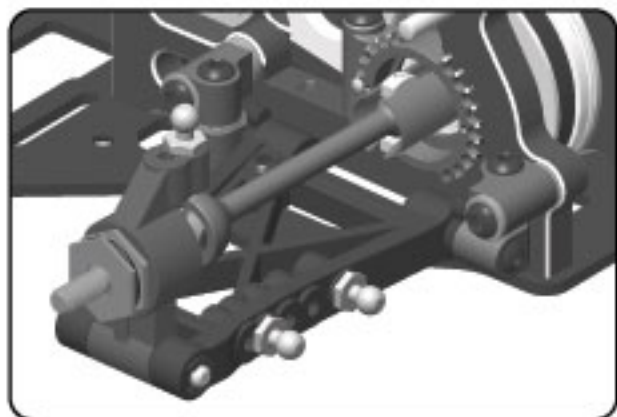
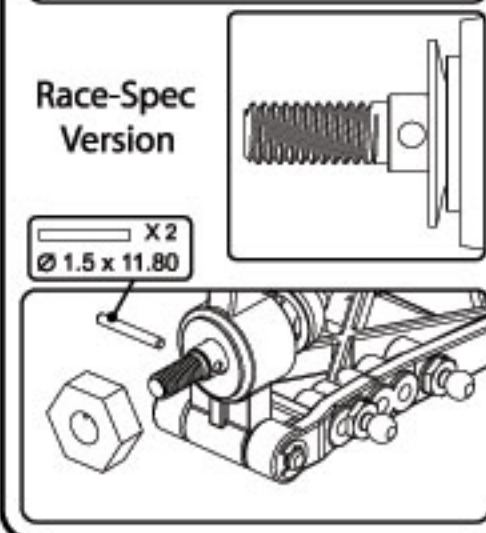
X2  
Ø 1.5 x 11.80



**1 Front Suspension Right hand Side**

M4 Pivot Ball

Ball Stud

Spacer

M3 Nyloc

5 x 10 x 4 x 2

M4 Pivot

Left Right

Minimum Gap

Minimum Gap

Adjust the kingpins for minimum gap with free movement

**Stage 6**

Carefully Pre-tap the Hub Carrier using a Nut Runner and the M4 Pivot, this will ensure easier assembly with the yoke with better alignment.

Ensure Free Movement of the Hub in the Yoke

**2**

O'Ring

1.5 x 9.80

Pro-Spec Version

Shim

Spring Washer

1.5 x 11.80

Race-Spec Version

**3**

M5 x 8

Ball Stud Ultra Short

Ball Stud

E clip x 2

Hub Must Lean Backwards

4

M3 x 16 x 2

Grey Washer 1mm x 2

2mm Kwik Clip x 2

M2.5 x 4 x 2

Stage 6 cont..

ENSURE THAT THE BLOCKS ARE CORRECTLY ASSEMBLED

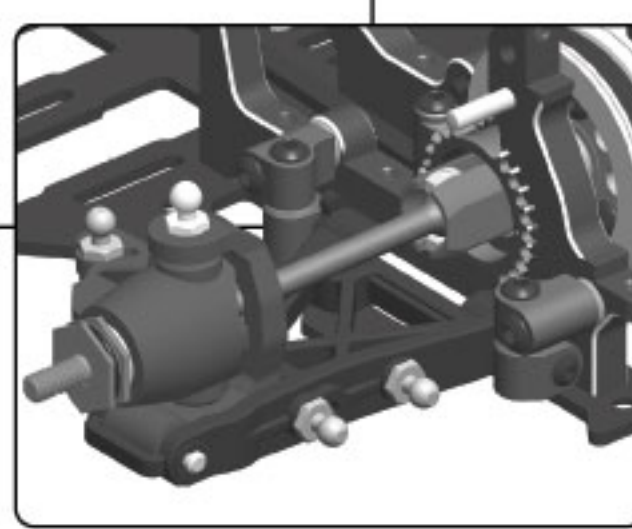
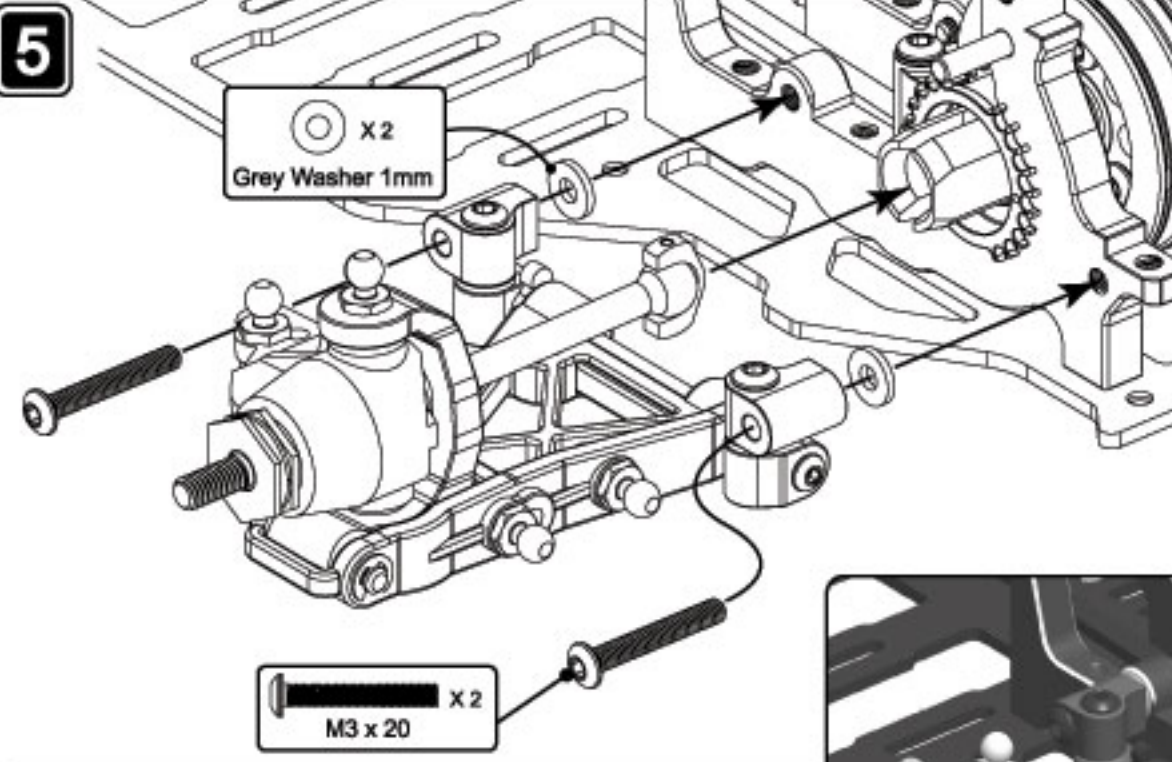

Use a washer to restrict steering lock and increase corner speed on outdoor tracks. very tight twisty tracks require more lock so the washer is not required.

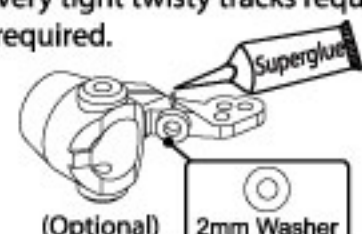

(Optional) 2mm Washer

**1****Front Suspension  
Left hand Side**

M4 Pivot Ball

Ensure Free Movement  
of the Hub in the Yoke

Carefully Pre-tap  
the Hub Carrier  
using a Nut Runner  
and the M4 Pivot,  
this will ensure  
easier assembly with  
the yoke with  
better alignment.

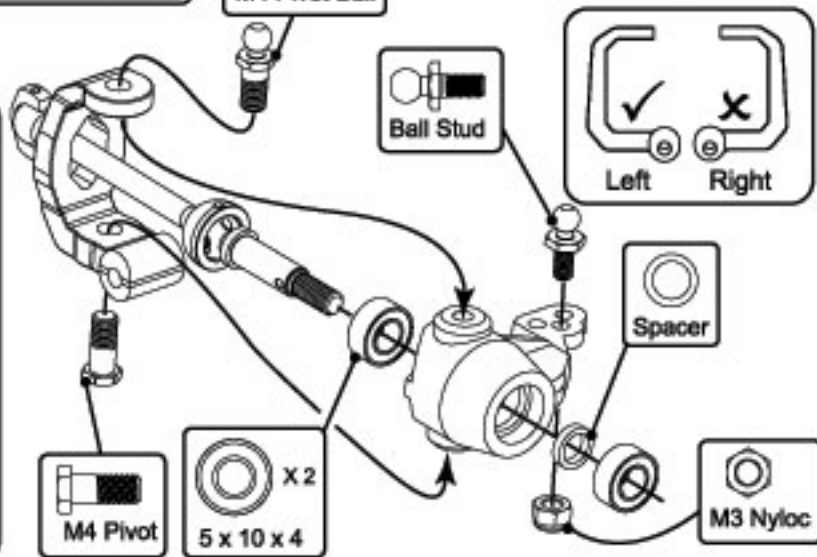
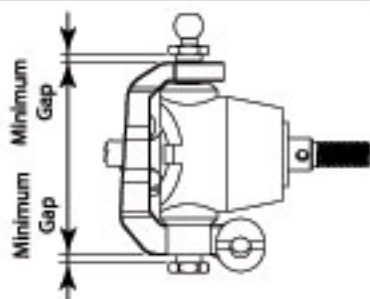
**Stage 6 cont...**

Adjust the kingpins for minimum gap with free movement

**2**Pro-Spec  
Version

Ø 1.5 x 9.80

O'Ring

Race-Spec  
Version

Shim

Spring Washer

Ø 1.5 x 11.80

**3**

M5 x 8

Ball Stud  
Ultra Short

Ball Stud

E clip X 2

Hub Must Lean Backwards



**4**

○ X2  
Grey Washer 1mm

— x2  
M3 x 16

⌋ X2  
2mm Kwik Clip

— X2  
M2.5 x 4



**Stage 6 cont...**

**ENSURE THAT THE BLOCKS ARE CORRECTLY ASSEMBLED**

**5**

○ X2  
Grey Washer 1mm

**L.H.S**

— X2  
M3 x 20

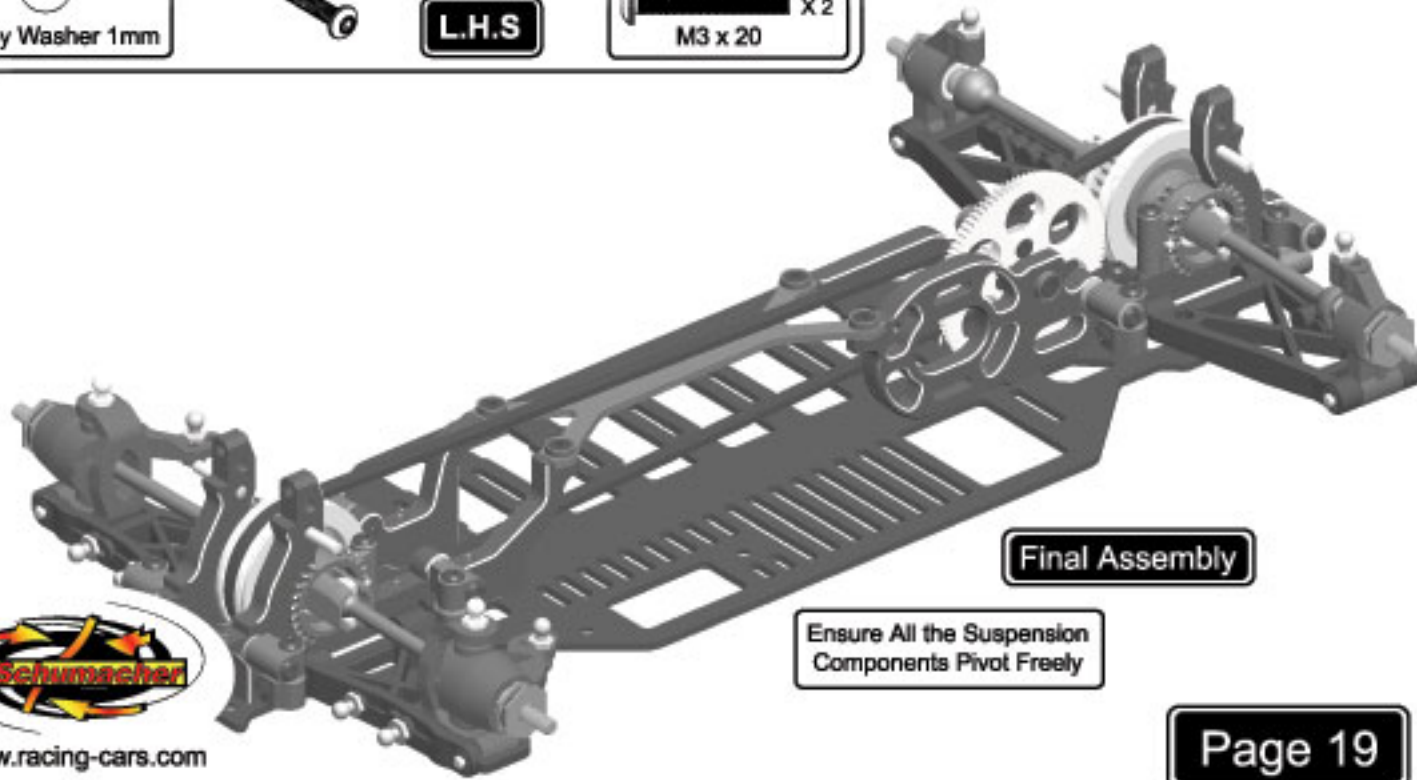
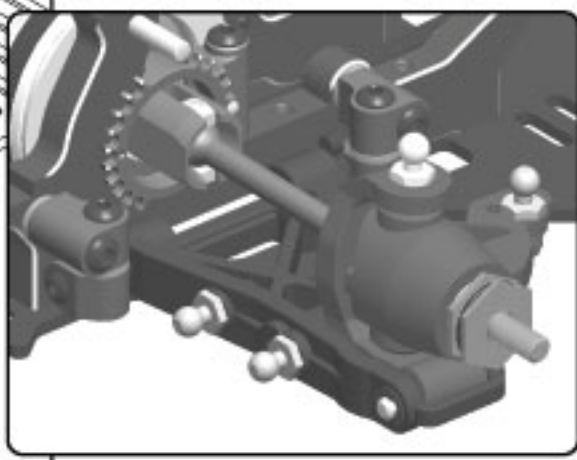

**Final Assembly**

**Ensure All the Suspension Components Pivot Freely**



1

X2  
M3 x 8

X2  
M3 x 3



Stage 7  
Pro-Spec

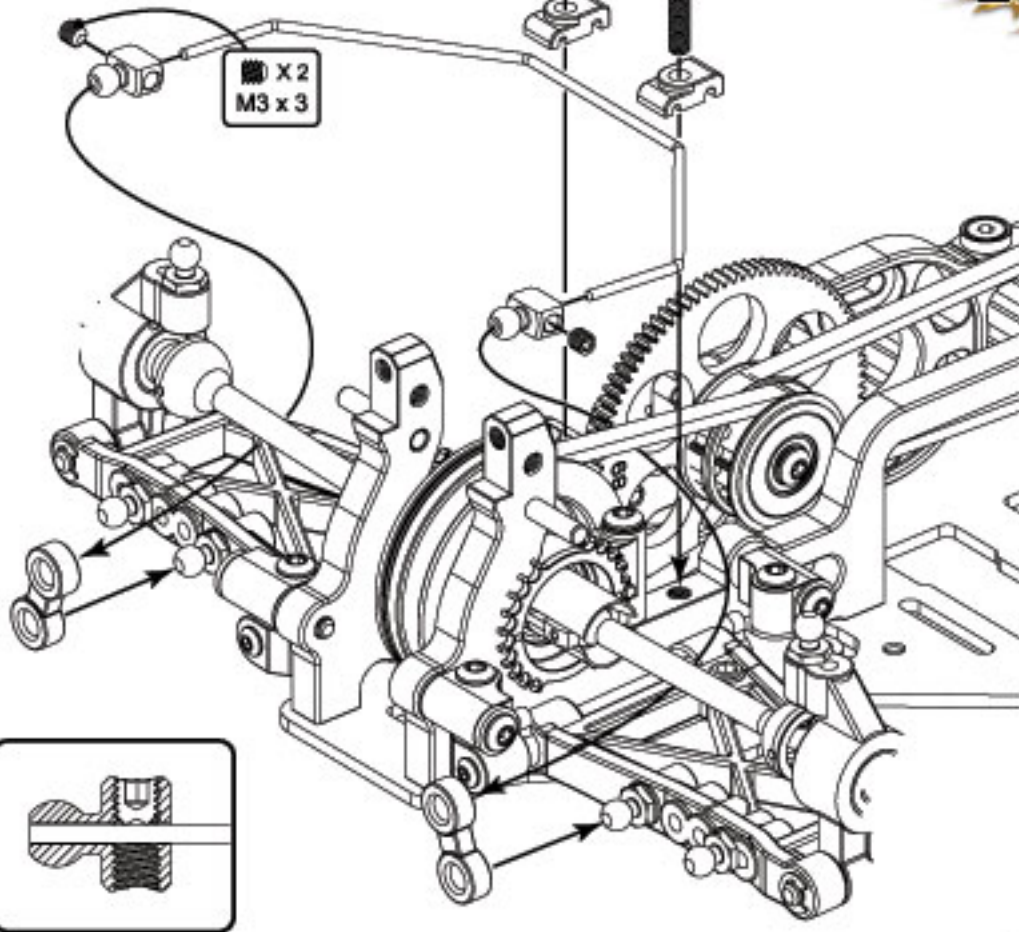
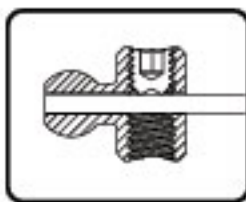

Final Assembly

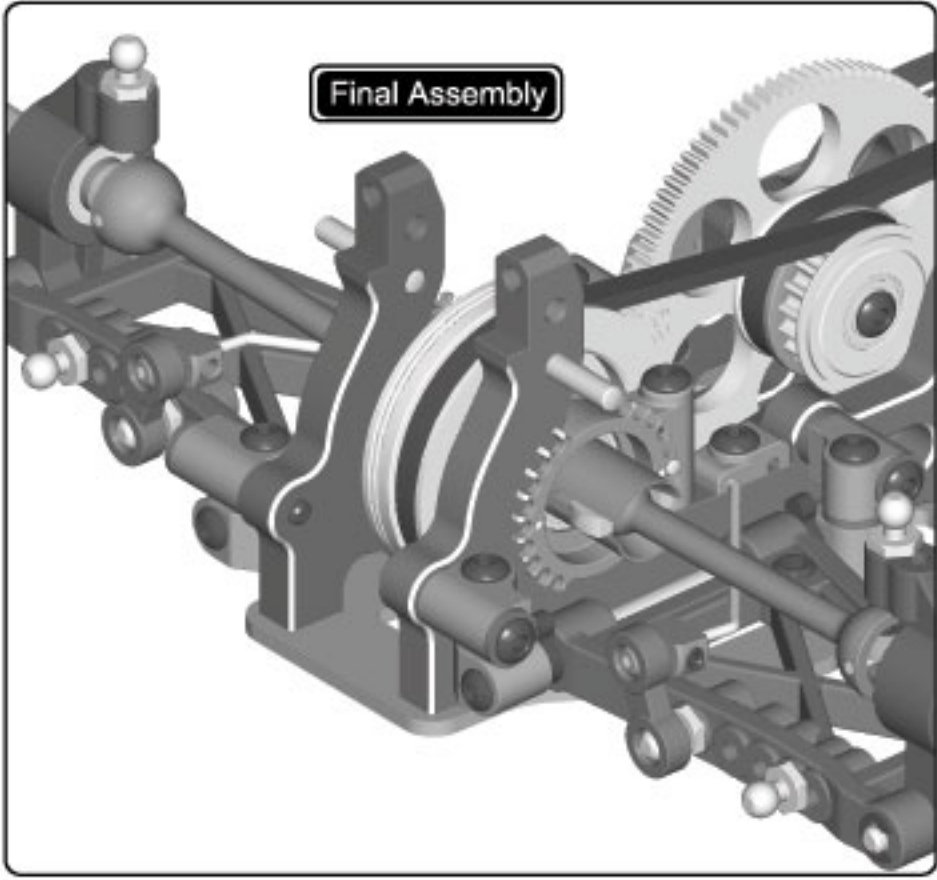



Stage 7 cont..  
Pro-Spec

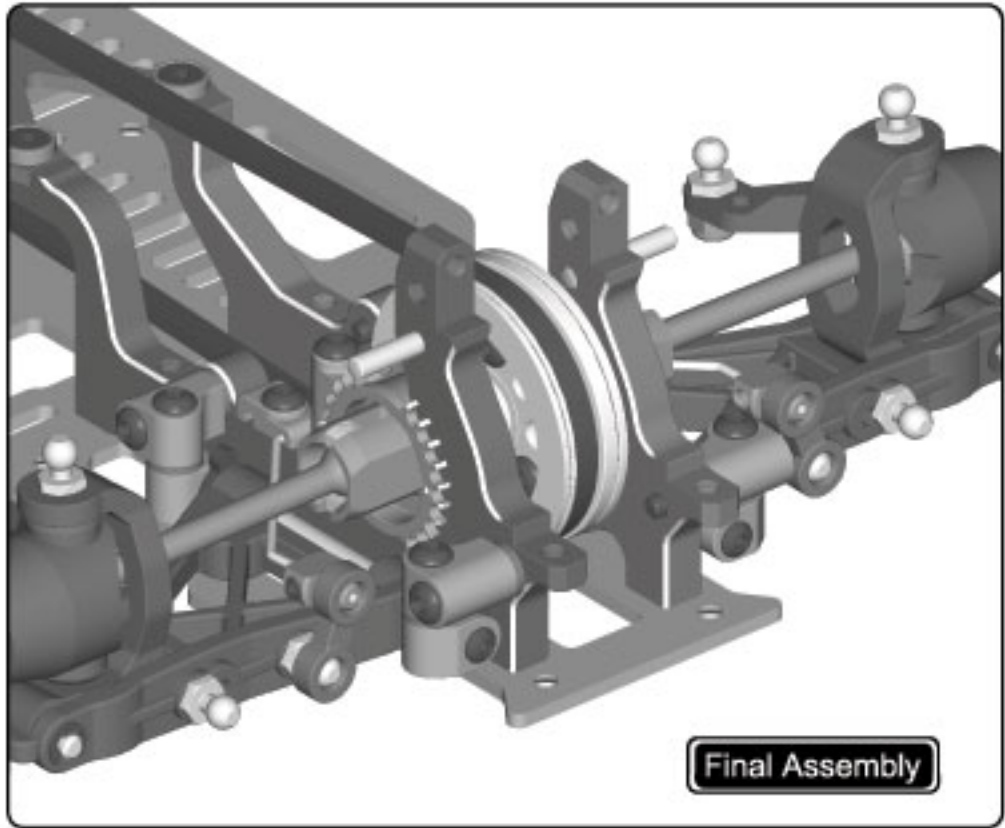
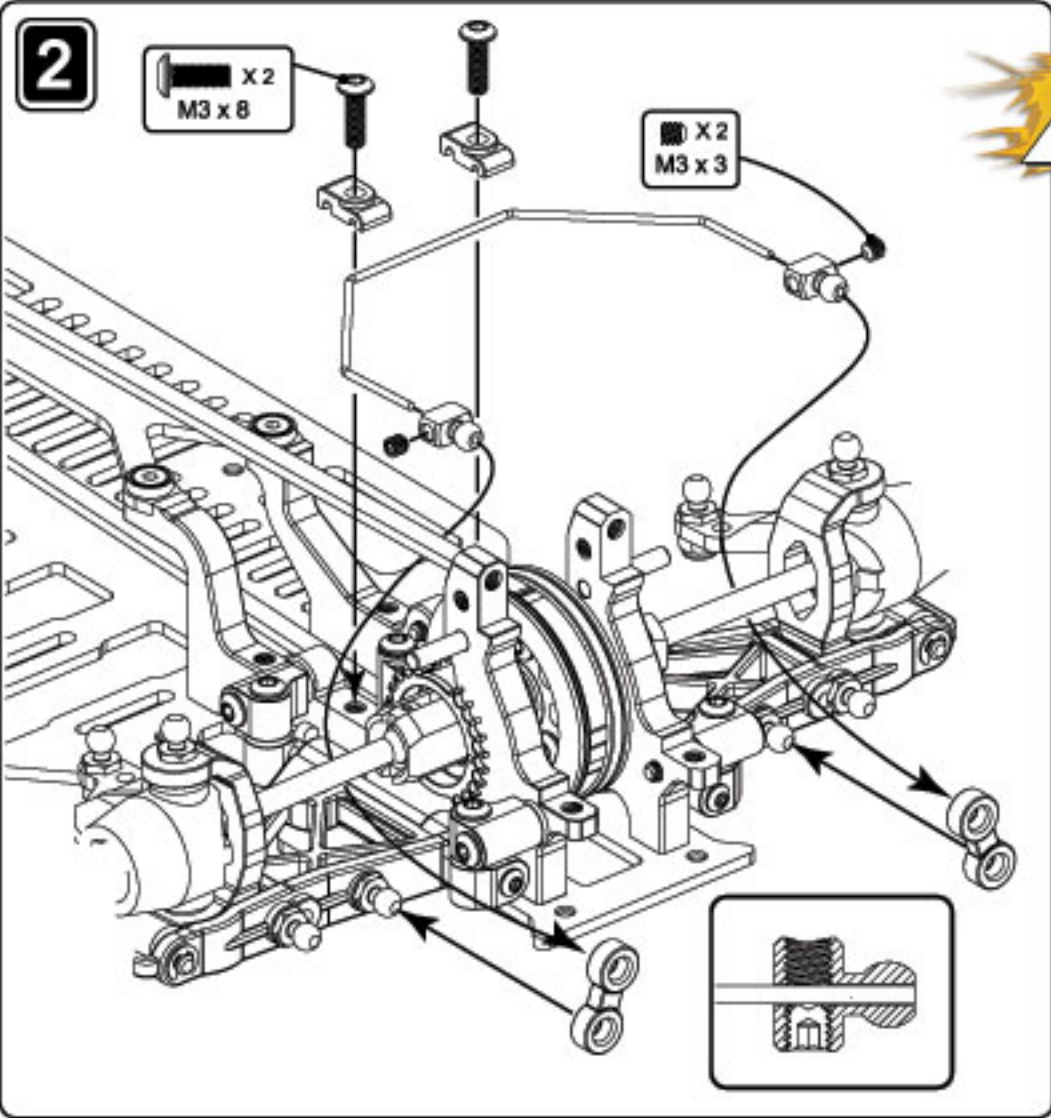
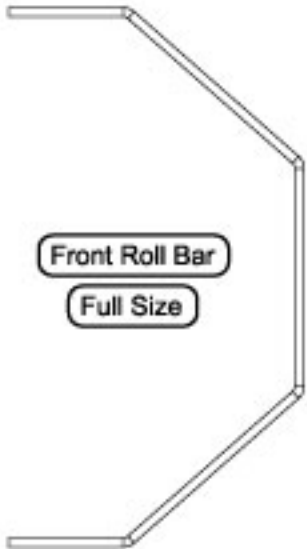

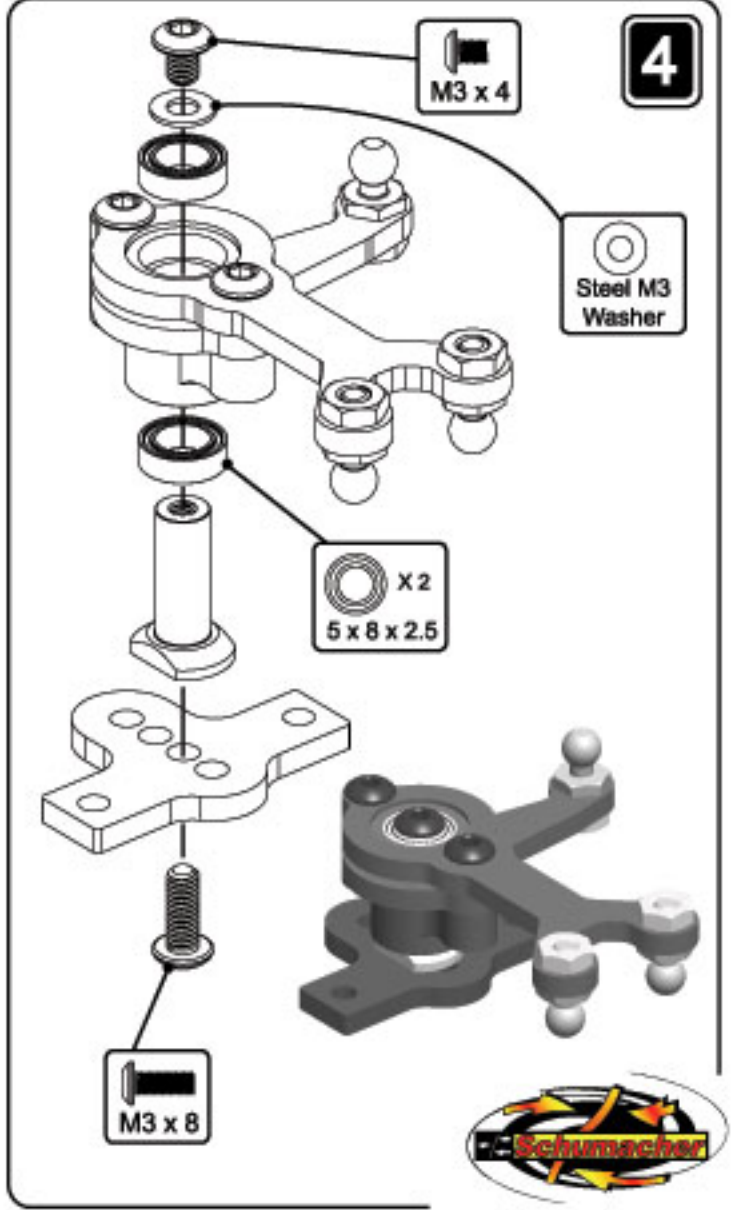
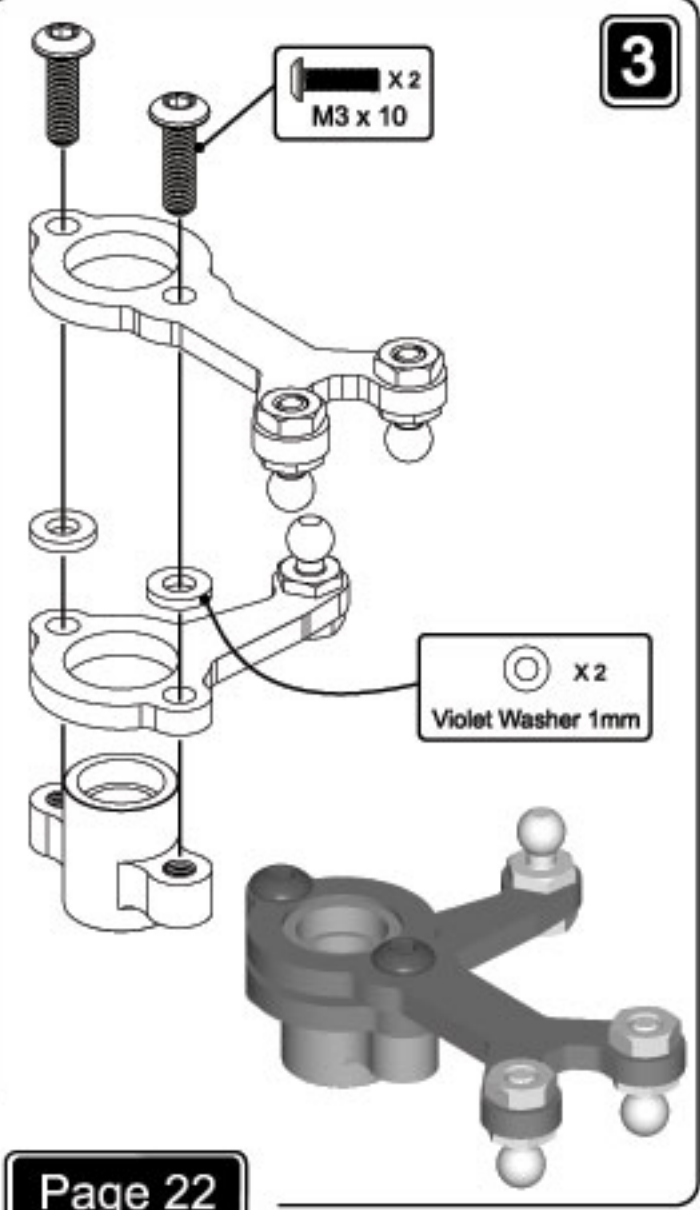
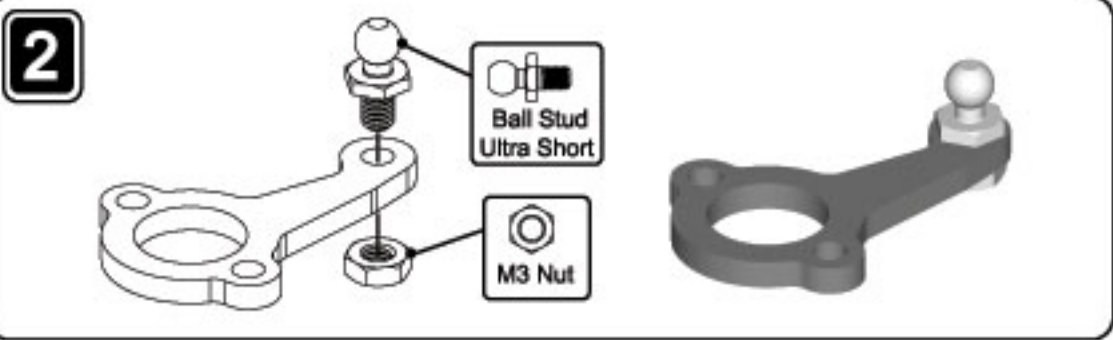
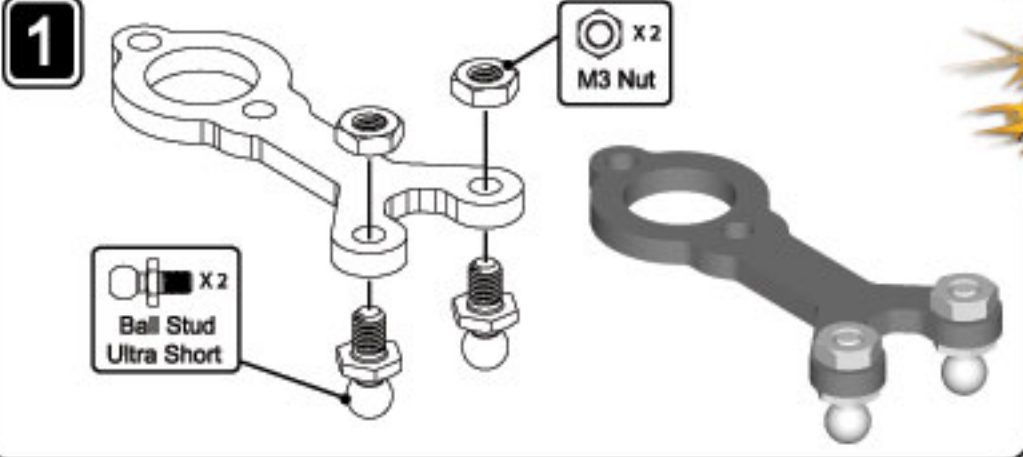

5

X 2  
M3 x 8



Stage 8 cont...

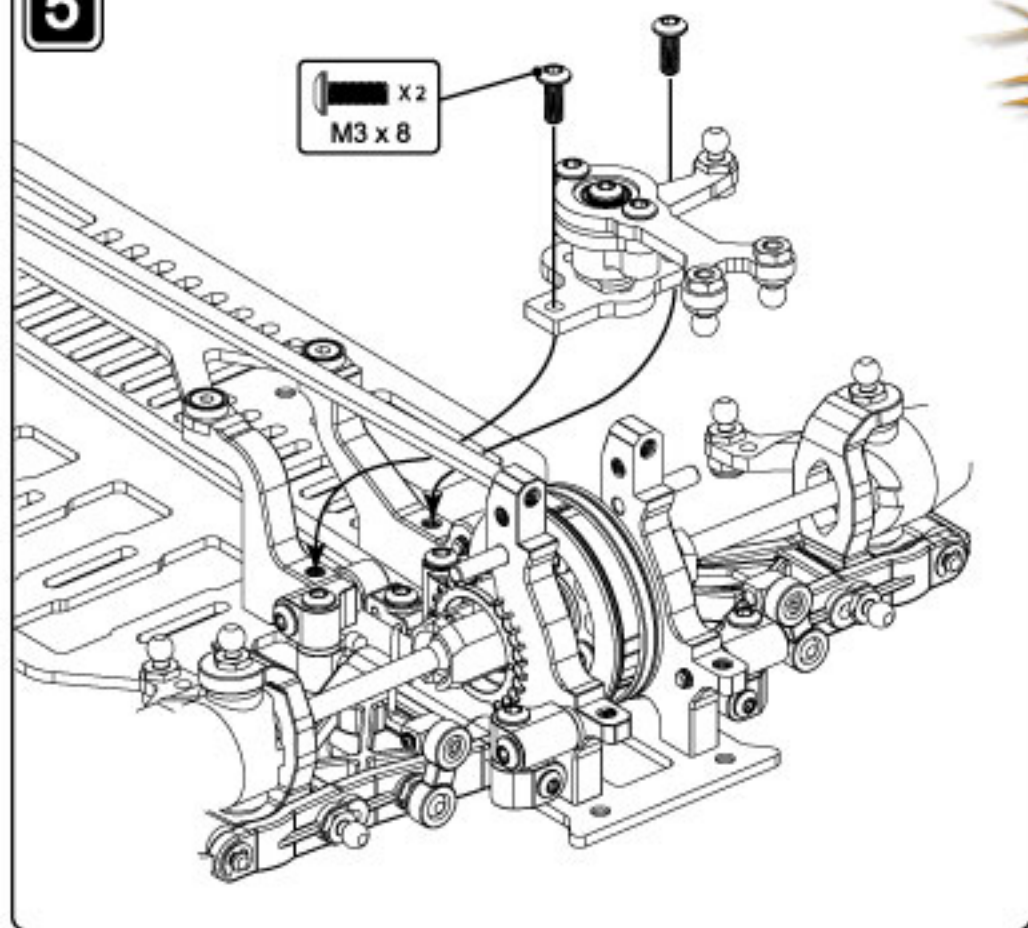

Final Assembly

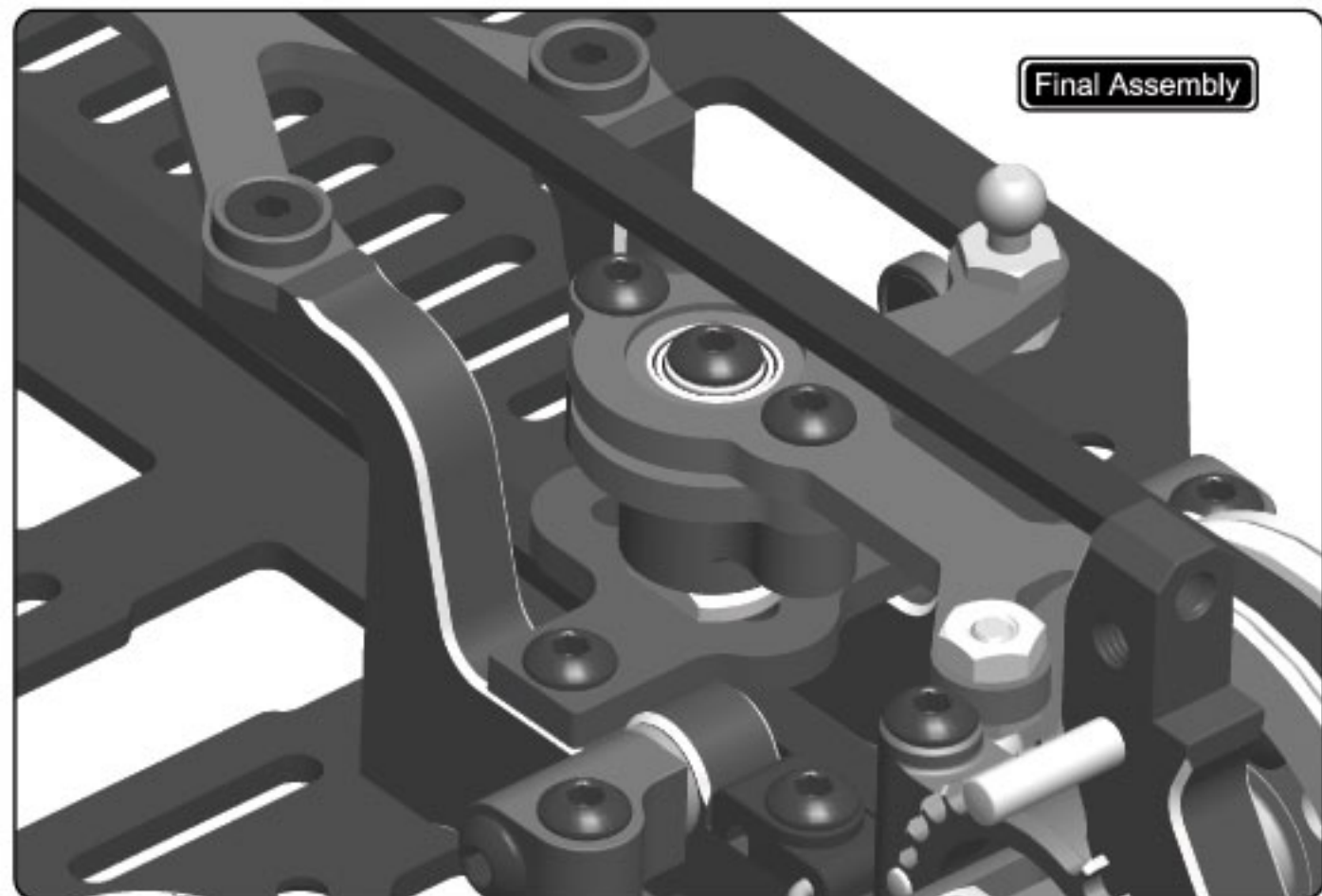



**1**Violet Washer  
2mmViolet Washer  
0.50mm

Ball Stud

Use the Long  
Ball stud if  
using more  
washers**2**

15.00mm (Rear Link)

35mm Turnbuckle

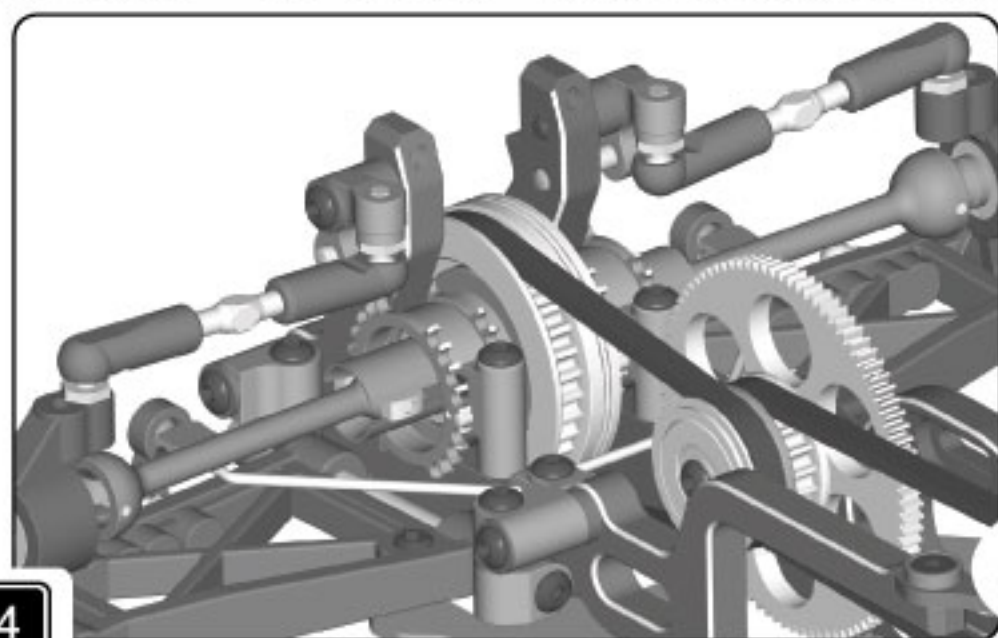
**Stage 9****3**X 2  
Grey Washer 1mmX 4  
Grey Washer 2mmX 2  
M3 x 16X 2  
Grey Washer 0.5mm

4

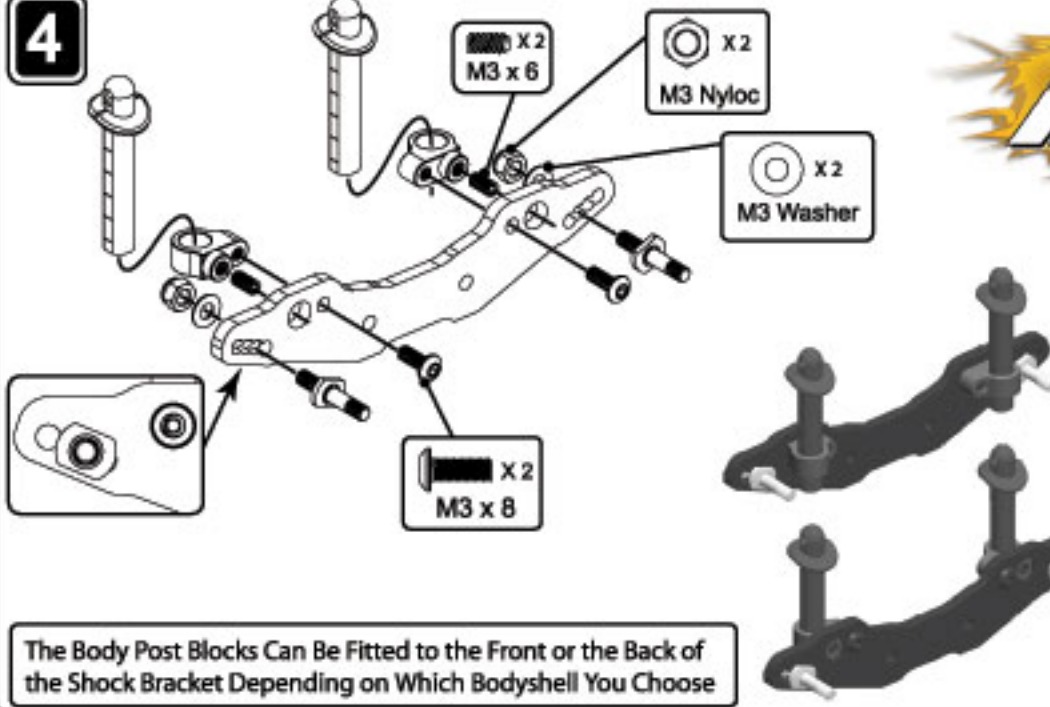

Stage 9 cont..  
+  
Bodymounting

The Body Post Blocks Can Be Fitted to the Front or the Back of the Shock Bracket Depending on Which Bodyshell You Choose

5

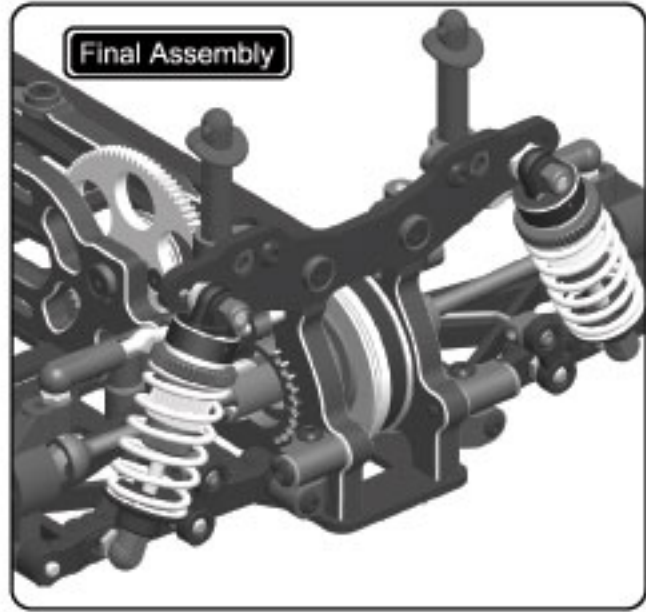
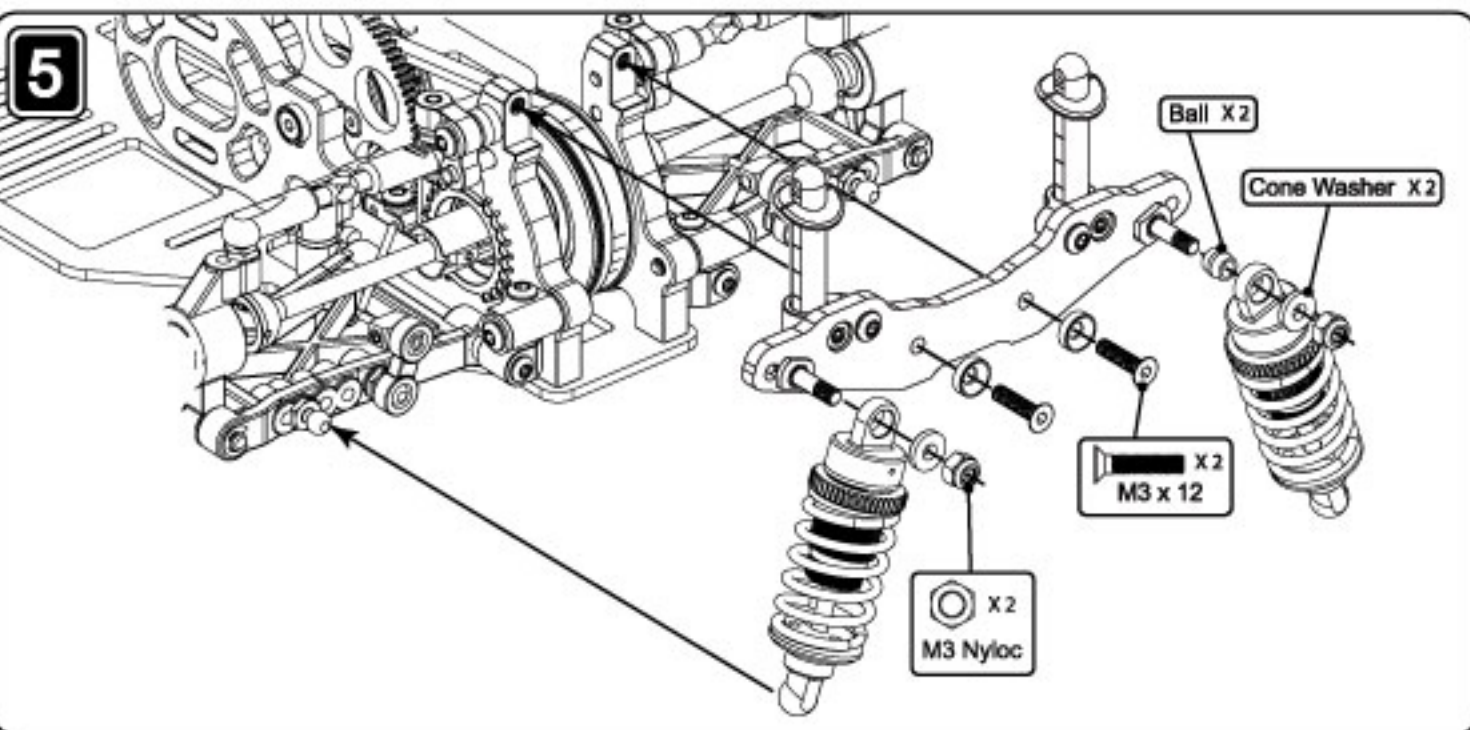

**1**

22.50mm (Front Track Rod)

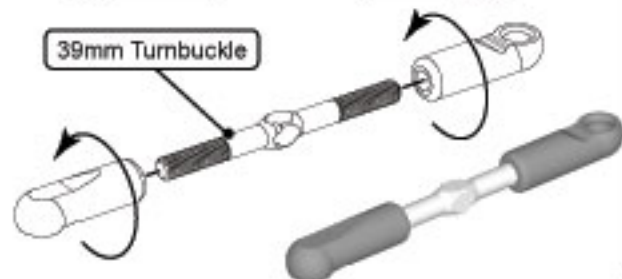

39mm Turnbuckle

**2**

14.50mm (Front Link)

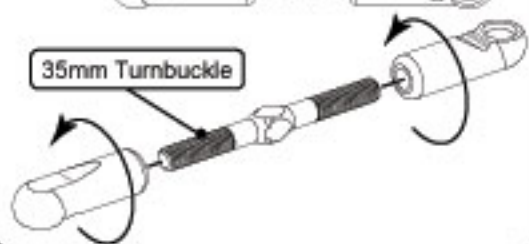

35mm Turnbuckle

**3**Violet Washer  
1mmUse the long  
ball studs if using  
more washers

Ball Stud

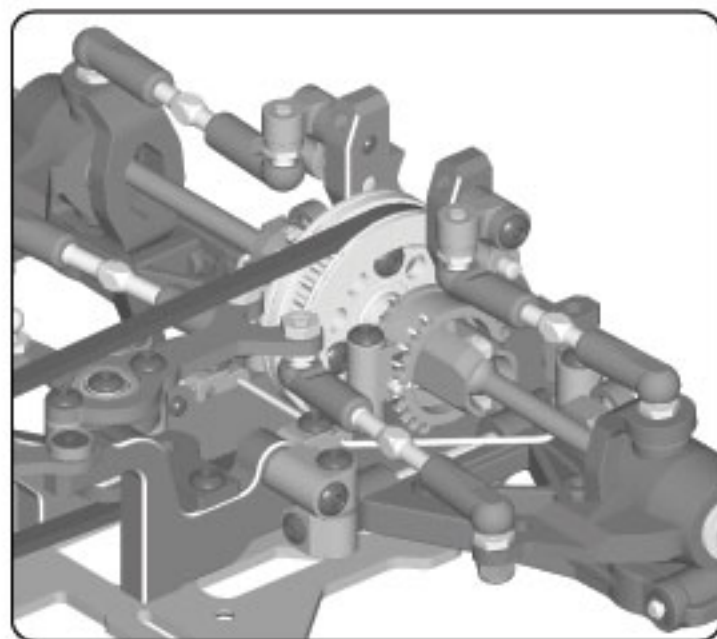
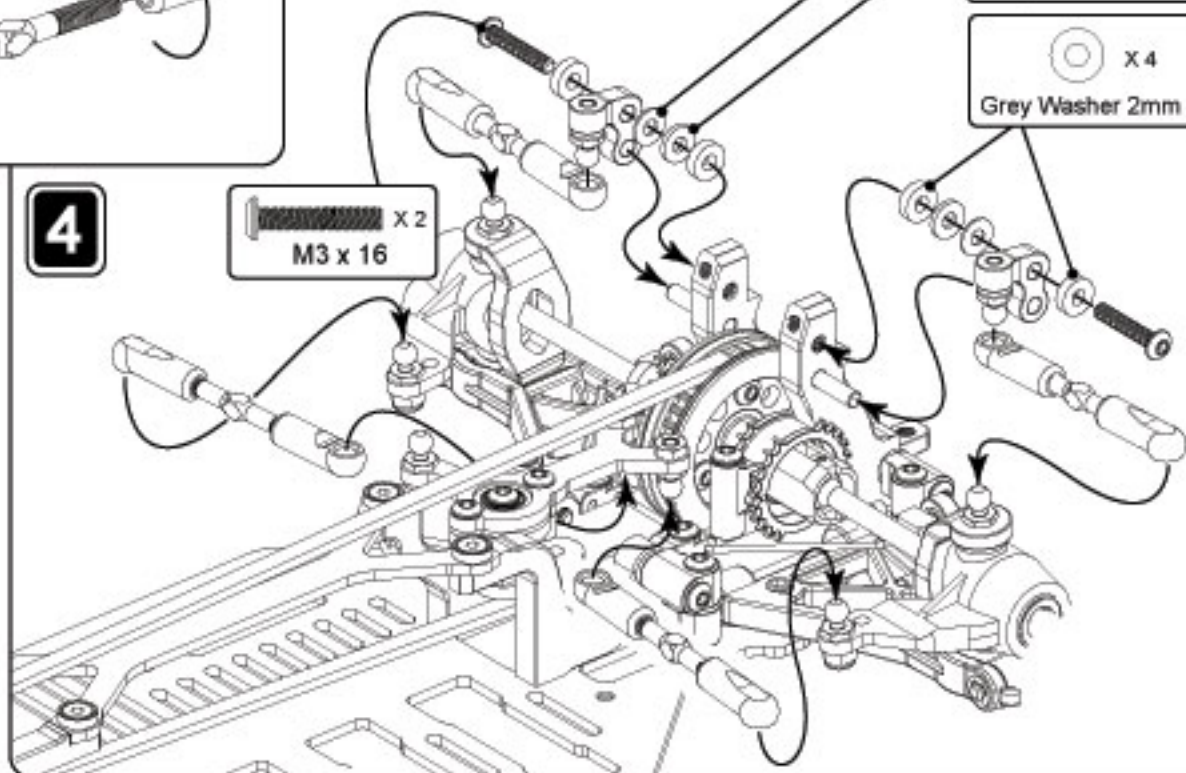
**Stage 10**x 2  
Grey Washer 0.5mmx 2  
Grey Washer 1mmx 4  
Grey Washer 2mm**4**x 2  
M3 x 16

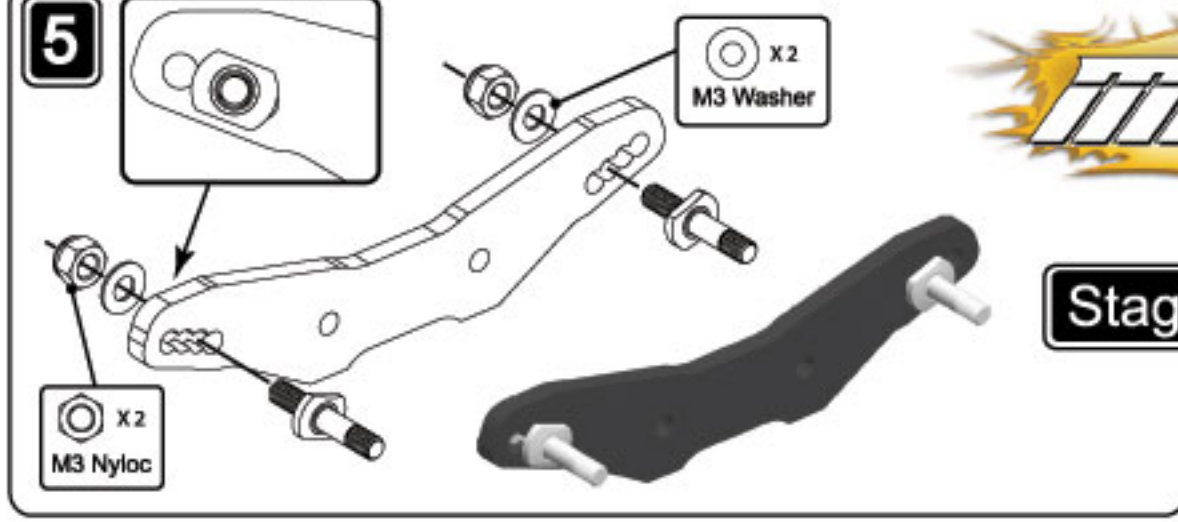

Stage 10 cont...

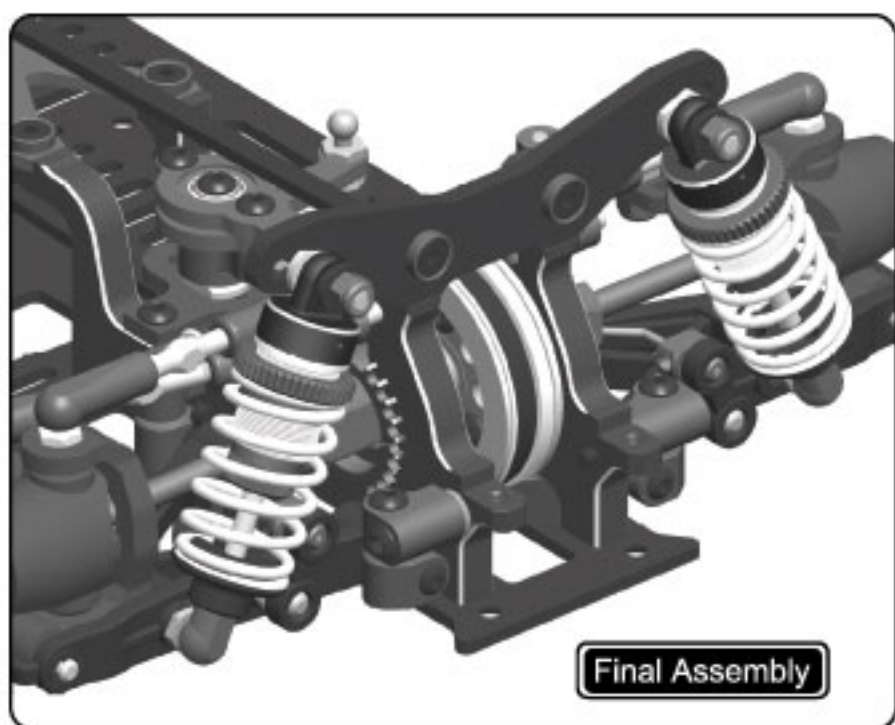
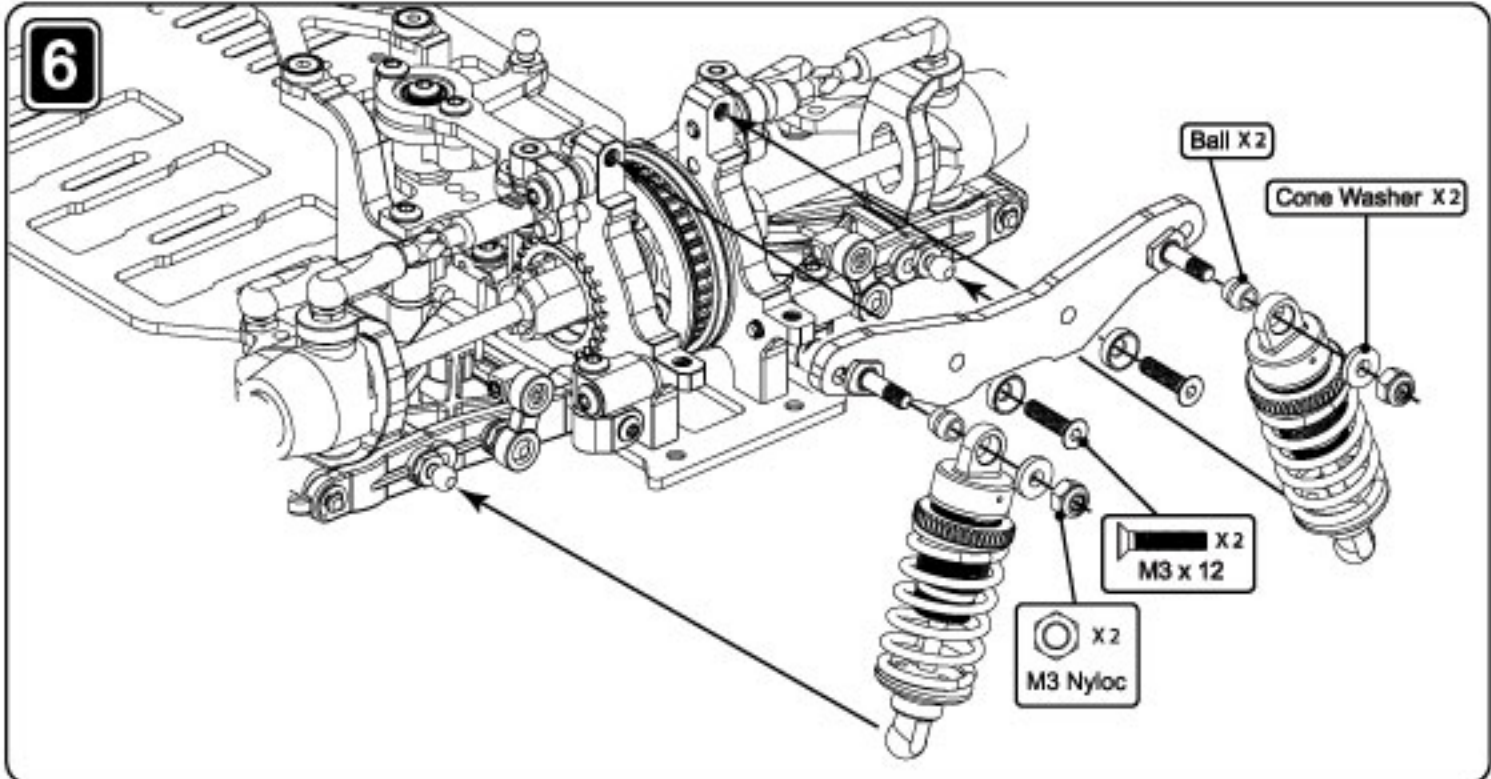

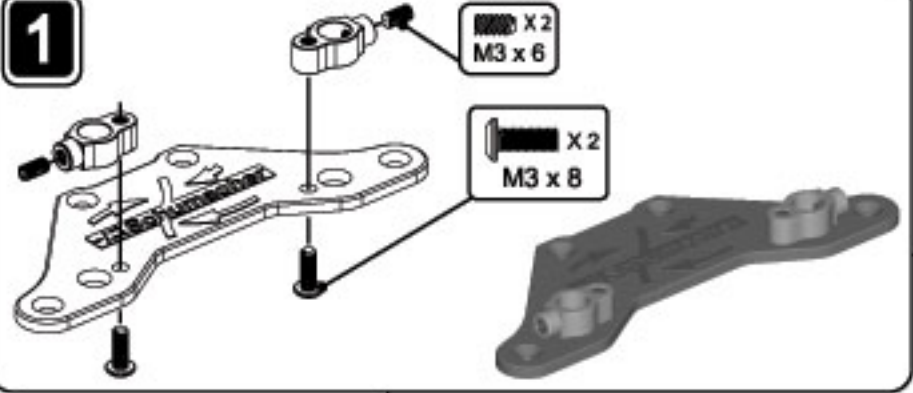

**Front Body Mounts and Bumper**

**2**

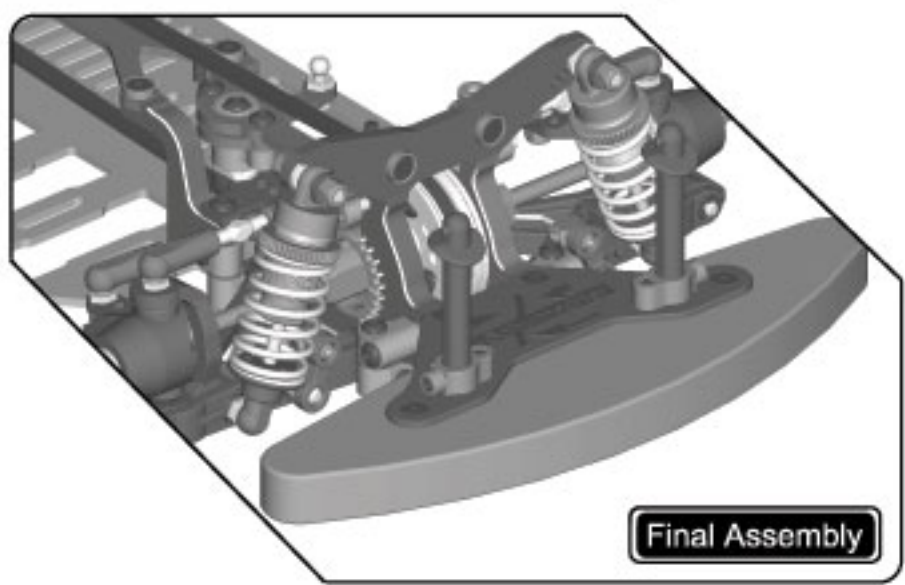
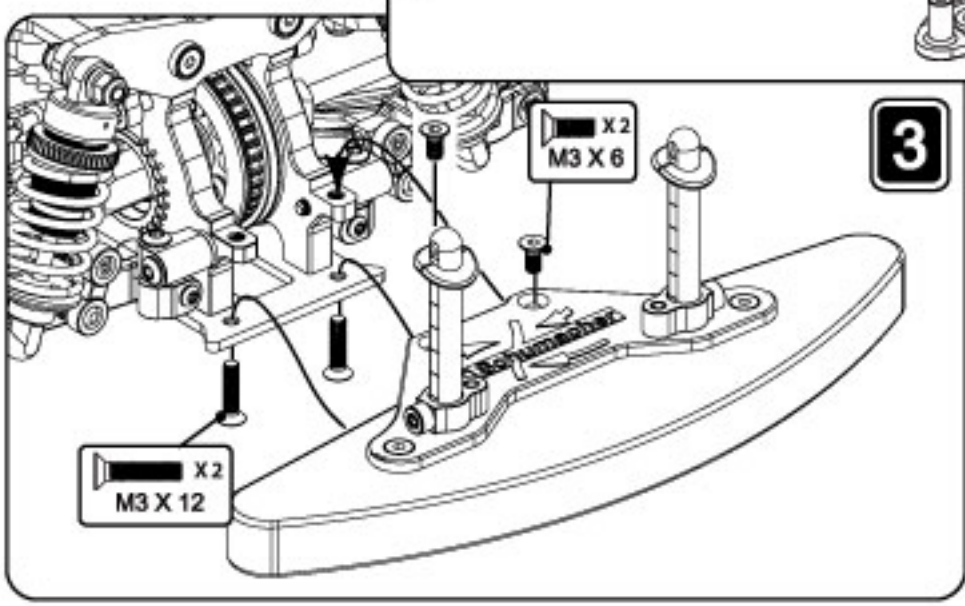
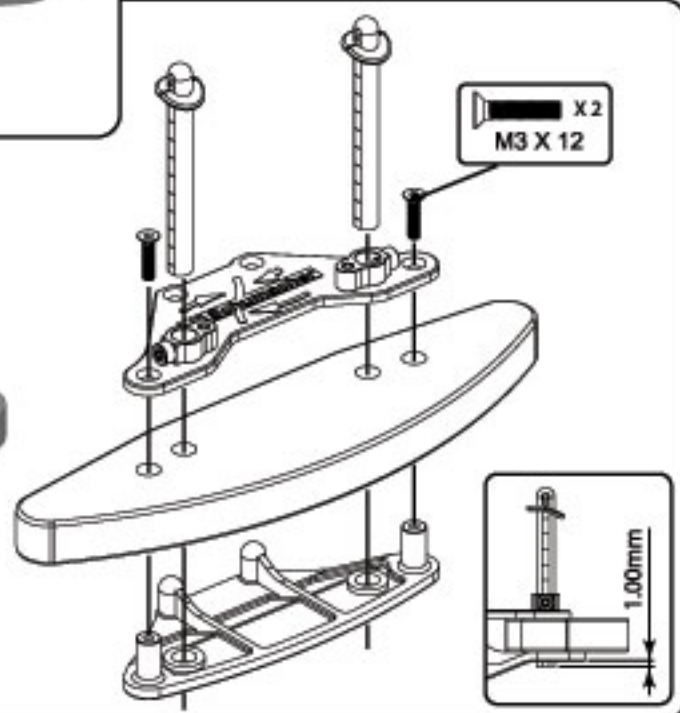

**1****SERVO SAVER OPTION**

CHOOSE THE CORRECT HORN FOR YOUR SERVO.  
 SA = SANWA/AIRTRONICS  
 FU = FUTABA  
 SH = SCHUMACHER/HITEC

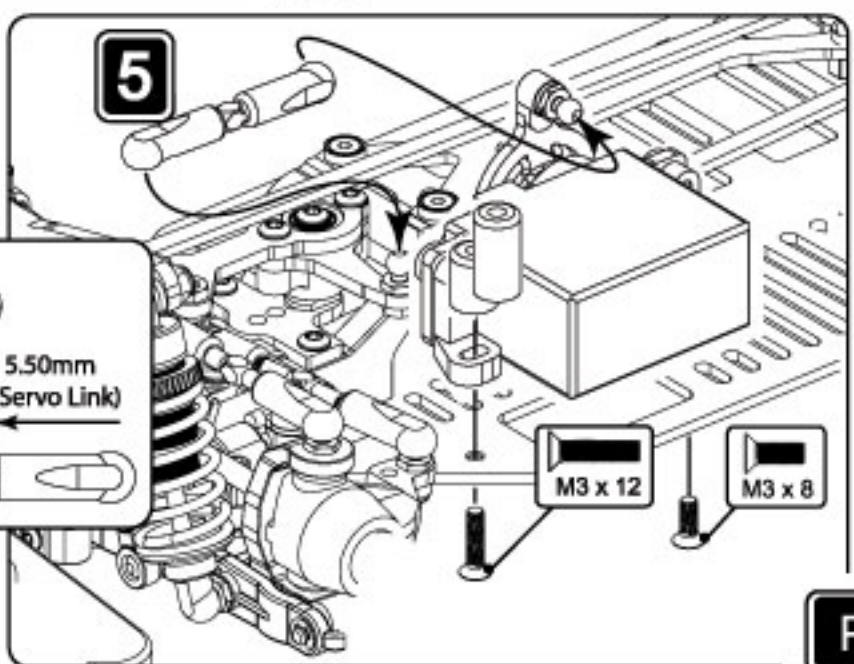
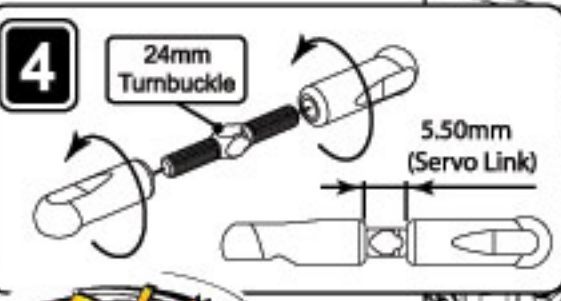
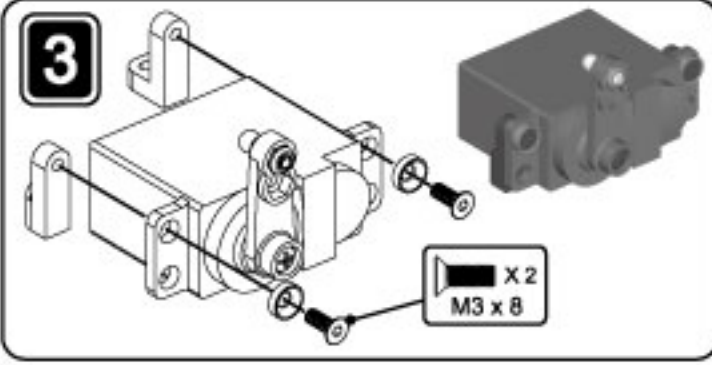
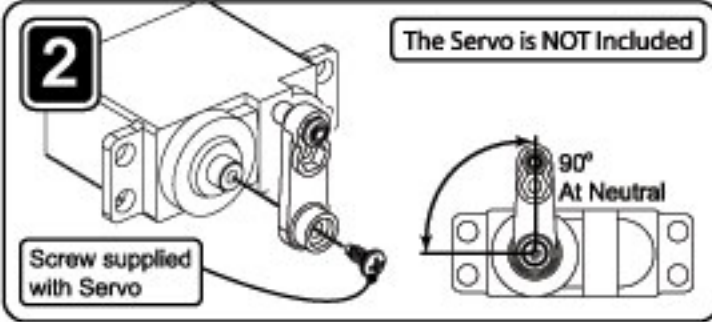
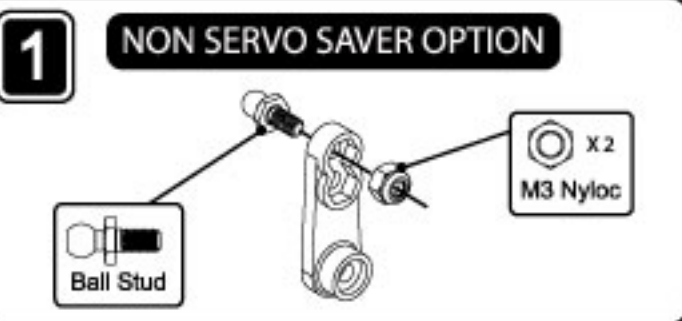
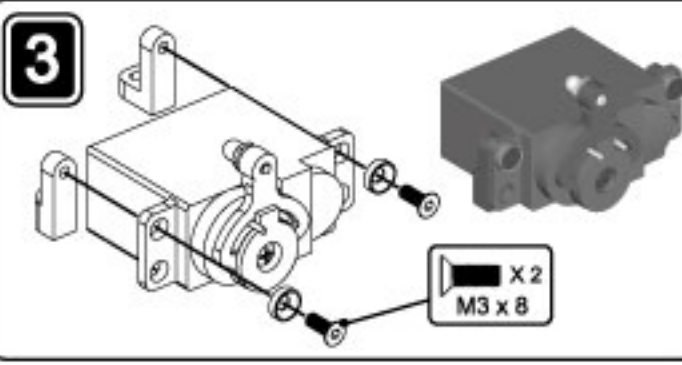
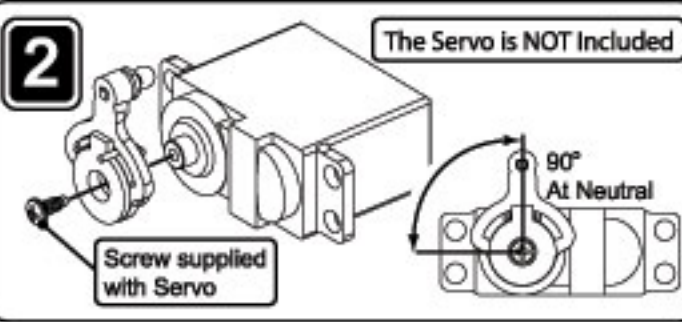
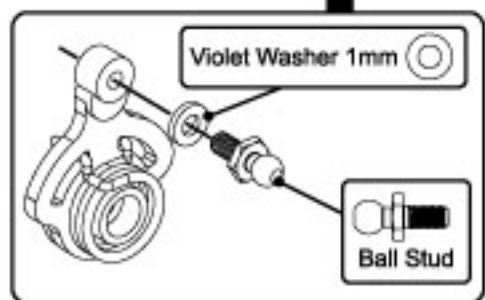
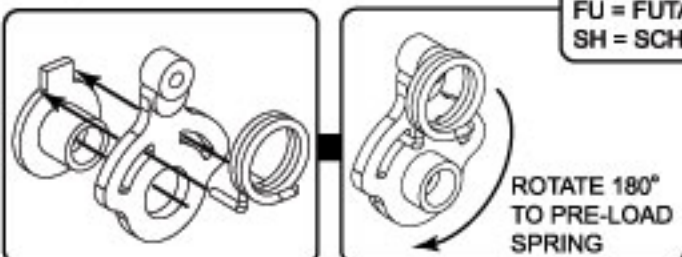
**Radio Installation**

6

The Motor and Pinion are NOT Included

X2  
M3 Washer

X2  
M3 x 8



Radio Installation cont...

7

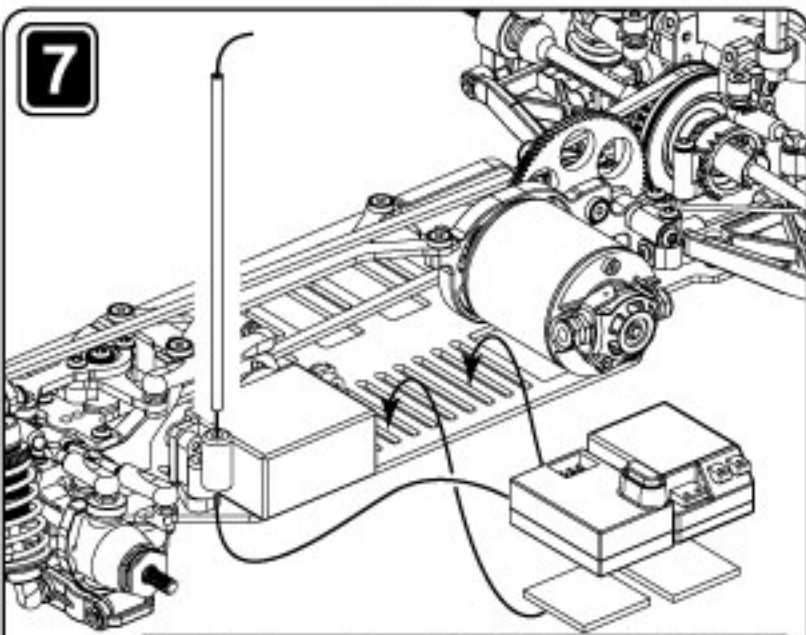

The Receiver and Speed Controller are NOT included

8

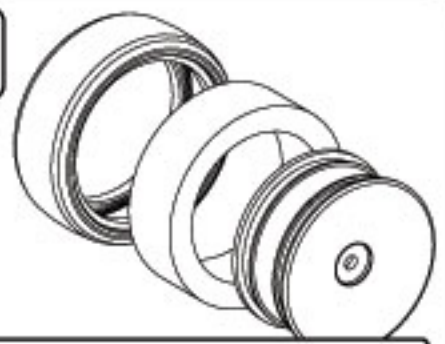

The Tyres and Inserts are NOT Included

When using the 5 Cell Chassis fit the Receiver behind the Cells.

9



X4  
Wheel Shim

X4  
M4 Nyloc

The Wheel Shims May not be Required with Some Wheels

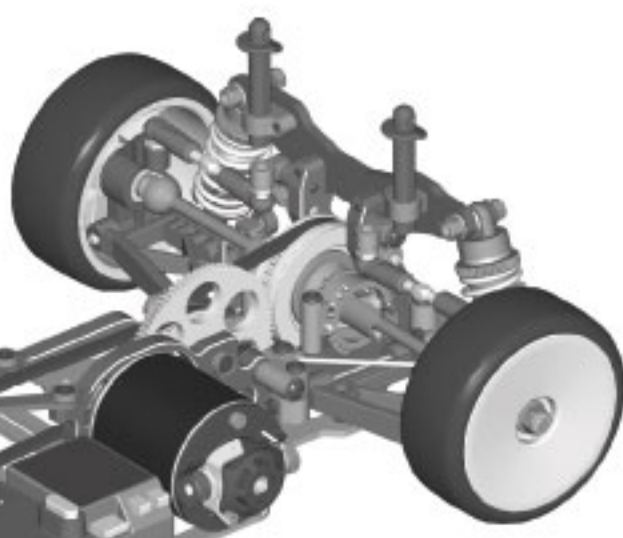

Final Assembly

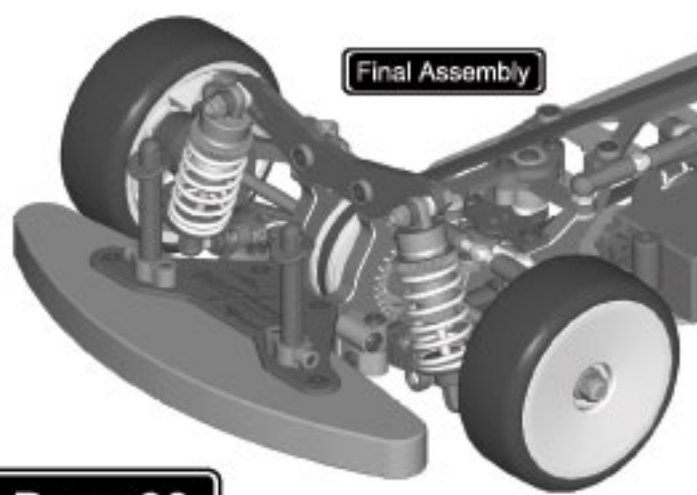

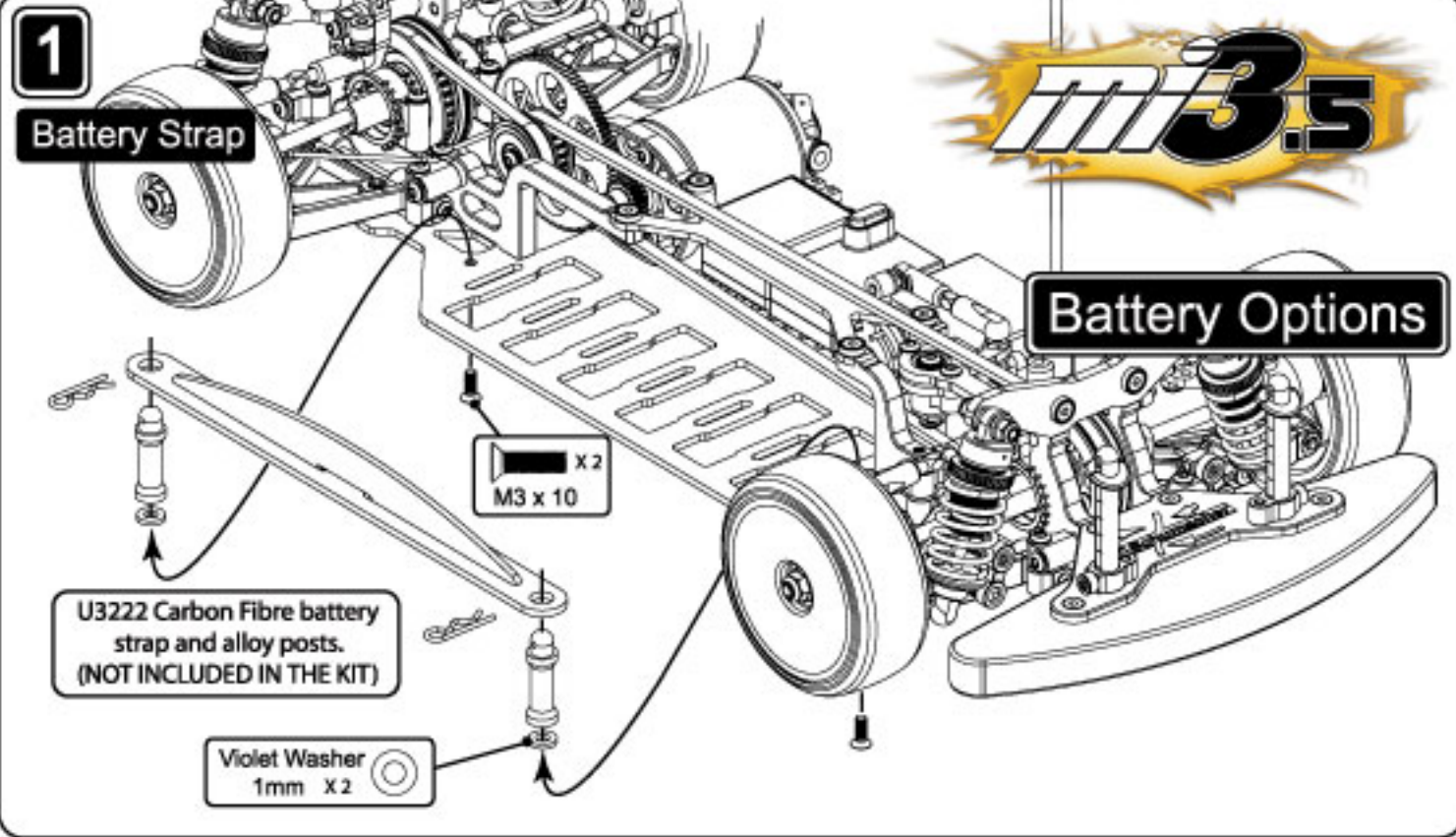

**1**

**Battery Strap**

**Battery Options**

**M3 x 10** X2

U3222 Carbon Fibre battery strap and alloy posts. (NOT INCLUDED IN THE KIT)

Violet Washer 1mm X2

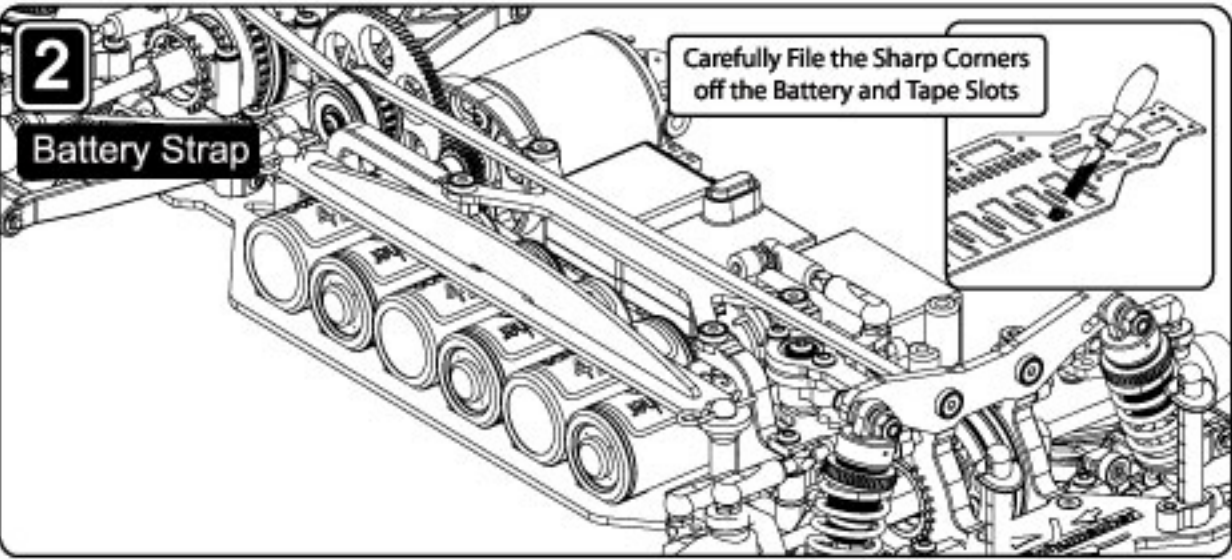

**2**

**Battery Strap**

Carefully File the Sharp Corners off the Battery and Tape Slots

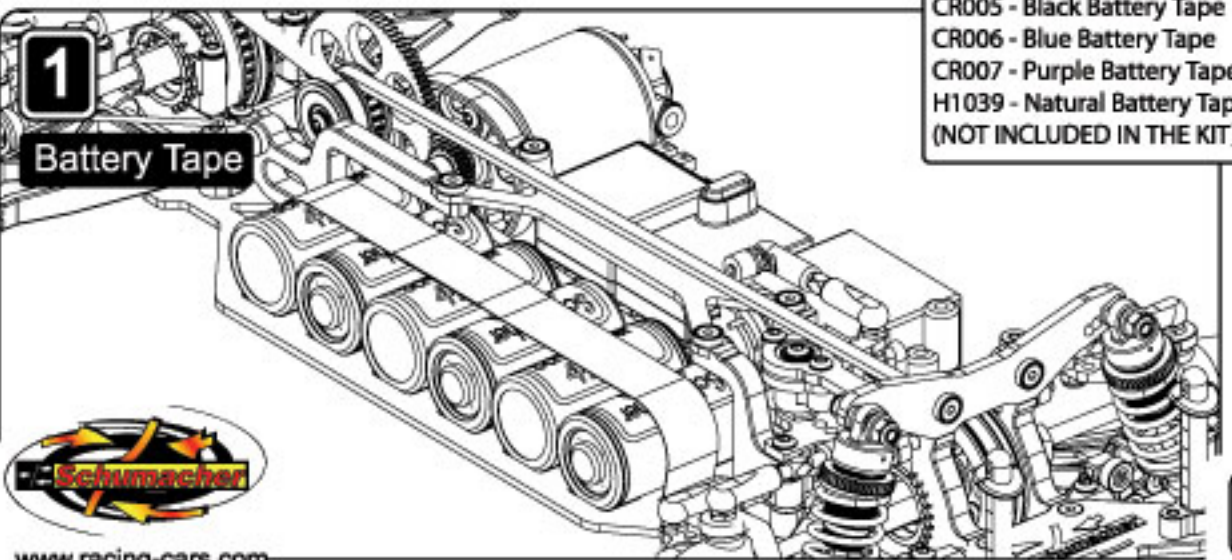

**1**

**Battery Tape**

CR005 - Black Battery Tape  
 CR006 - Blue Battery Tape  
 CR007 - Purple Battery Tape  
 H1039 - Natural Battery Tape  
 (NOT INCLUDED IN THE KIT)





## SPRINGS

The spring rate controls the suspension stiffness. Spring adjusters only change the ride height. They DO NOT alter the suspension stiffness. On slippery or bumpy tracks use soft to medium rate springs, on flat or high grip tracks run medium to hard rate springs.

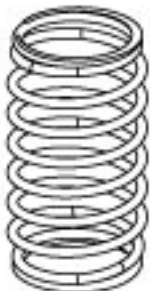

## STEERING

With the Ball centres Closer together you will get a more aggressive steering response, and further apart will give a less aggressive steering response. The options are available when you purchase, U3135 Steering Set

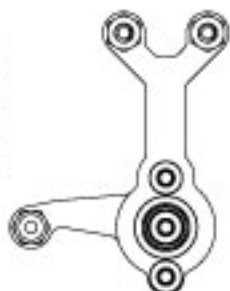

## Track Settings

### FRONT CASTOR

The front castor can be altered by changing the yoke. The car comes with 4° castor as standard. Less castor will give a quicker steering response, but could lead to power on understeer. More castor will give the opposite, slightly slower turn in, but more power on steering.

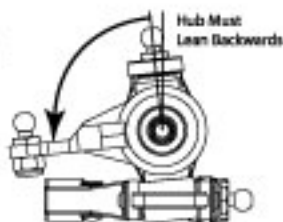

### SHOCK BRACKETS (Shock Mounting)

Vertical shock absorbers make the car react sharply to driver inputs.

A laydown shock offers a softer feel to the driver.

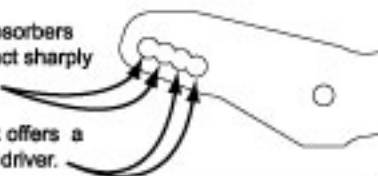

### RIDE HEIGHT

In general always run the car as low as possible, without the chassis grounding out, as it rolls into corners.

A good starting point with rubber tyres is 5.5mm at the front and 6.0mm at the rear.

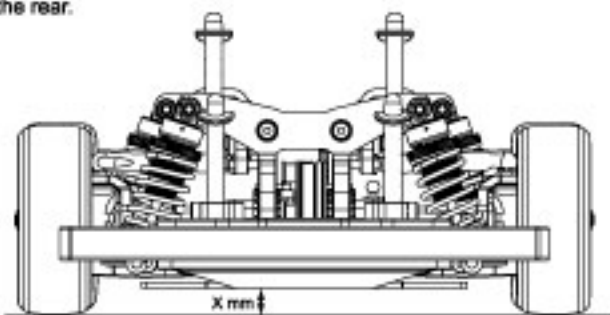

### FRONT & REAR CAMBER

With maximum negative camber the car will have high levels of grip, but there may be the possibility of sudden breakaway in corners. Reducing the camber gives a more progressive slide, but may give less grip.

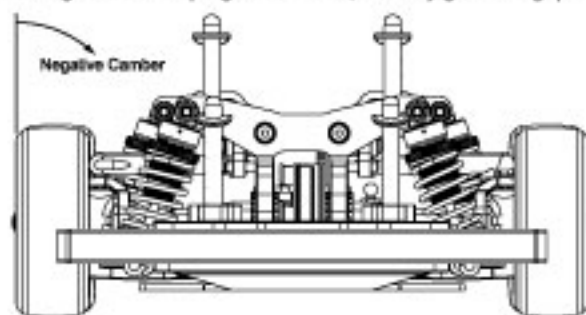

### FRONT TOE-IN (Out-board)

The front toe-in is set by adjusting the steering trackrod turnbuckles.

Toe-In = A less than B  
Toe-Out = A greater than B

Toe-in will give a more stable car, but will give less sharp turn in. Toe-out will give the opposite, less stability with sharper turn in to the corners. We recommend to start at about 0° or 1° toe-out.

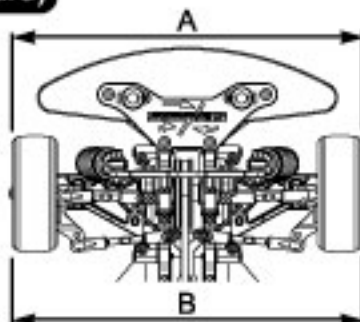

### FRONT AND REAR TRACK WIDTH

TRACK WIDTH ADJUSTMENT (In-board)

The track width of the car may be altered by adding or removing equal thickness grey suspension washers between the Screw blocks and the transmission housings. When changing the track width ensure the driveshafts are fully engaged in the Diff outputs. And the width does not exceed 190mm

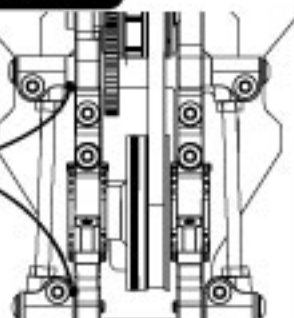

### FRONT AND REAR WHEELBASE

WHEELBASE ADJUSTMENT (In-board)

The wheelbase may be adjusted by moving the Qwik clips to either the front or the back of the wishbones. This alters the front to rear weight Balance of the car.

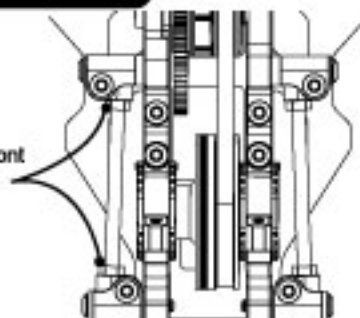

### FRONT AND REAR INBOARD TOE-IN

TOE IN (In-board)

The toe-in is set by adding or removing the grey suspension washers between the Screw blocks and the transmission housings, at the front or rear of the wishbones. Each 0.50mm washer will change the Toe in by Approx 0.6°

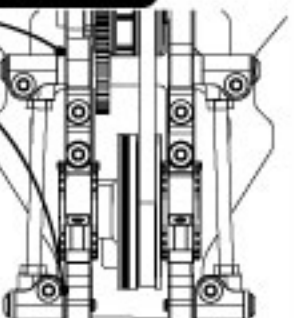

**BATTERY OPTIONS**

5 Cell (With Strap or Tape)

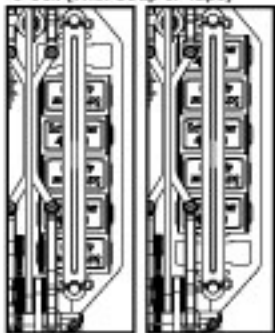
**BATTERY OPTIONS**

4 Cell (With Strap or Tape)

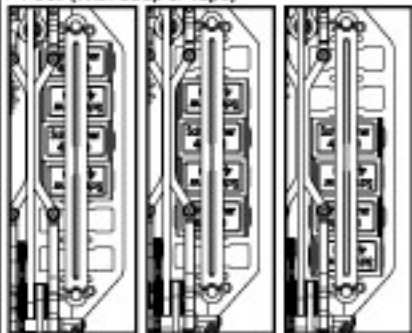
**Track Settings****GEAR CHART 48Dp**

Maximum Tooth Sum = 121.....Minimum Tooth Sum = 91.....Internal Ratio = 1.8:1

|    | 14    | 15    | 16    | 17   | 18   | 19   | 20   | 21   | 22   | 23   | 24   | 25   | 26   | 27   | 28   | 29   | 30   | 31   | 32   | 33   | 34   | 35   | 36   | 37   | 38   |  |
|----|-------|-------|-------|------|------|------|------|------|------|------|------|------|------|------|------|------|------|------|------|------|------|------|------|------|------|--|
| 89 | 11.44 | 10.66 | 10.01 | 9.42 | 8.90 | 8.43 | 8.01 | 7.63 | 7.28 | 6.97 | 6.68 | 6.41 | 6.16 | 5.93 | 5.72 | 5.52 | 5.34 | 5.17 | 5.01 |      |      |      |      |      |      |  |
| 87 | 11.18 | 10.44 | 9.79  | 9.21 | 8.70 | 8.24 | 7.83 | 7.46 | 7.12 | 6.81 | 6.53 | 6.26 | 6.02 | 5.80 | 5.59 | 5.40 | 5.22 | 5.05 | 4.89 | 4.75 | 4.61 |      |      |      |      |  |
| 85 | 10.92 | 10.20 | 9.56  | 9.00 | 8.50 | 8.05 | 7.65 | 7.29 | 6.95 | 6.65 | 6.38 | 6.12 | 5.88 | 5.67 | 5.46 | 5.28 | 5.10 | 4.94 | 4.78 | 4.64 | 4.50 | 4.37 | 4.25 |      |      |  |
| 70 |       |       |       |      |      |      |      | 6.00 | 5.73 | 5.48 | 5.25 | 5.04 | 4.85 | 4.67 | 4.50 | 4.34 | 4.20 | 4.08 | 3.94 | 3.82 | 3.71 | 3.60 | 3.50 | 3.41 | 3.32 |  |
| 66 |       |       |       |      |      |      |      |      |      |      |      | 4.75 | 4.57 | 4.40 | 4.24 | 4.10 | 3.96 | 3.83 | 3.71 | 3.60 | 3.49 | 3.39 | 3.30 | 3.21 | 3.13 |  |

**GEAR CHART 64Dp**

Maximum Tooth Sum = 161.....Minimum Tooth Sum = 121.....Internal Ratio = 1.8:1

|     | 19    | 20    | 21    | 22   | 23   | 24   | 25   | 26   | 27   | 28   | 29   | 30   | 31   | 32   | 33   | 34   | 35   | 36   | 37   | 38   | 39   | 40   | 41   | 42   | 43   | 44   | 45   | 46   | 47   | 48   | 49   | 50   |
|-----|-------|-------|-------|------|------|------|------|------|------|------|------|------|------|------|------|------|------|------|------|------|------|------|------|------|------|------|------|------|------|------|------|------|
| 118 | 11.18 | 10.62 | 10.11 | 9.65 | 9.23 | 8.85 | 8.50 | 8.17 | 7.87 | 7.58 | 7.32 | 7.08 | 6.85 | 6.64 | 6.44 | 6.25 | 6.07 | 5.90 | 5.74 | 5.58 | 5.44 | 5.31 | 5.18 | 5.05 | 4.93 |      |      |      |      |      |      |      |
| 116 | 10.99 | 10.44 | 9.94  | 9.49 | 9.08 | 8.70 | 8.35 | 8.03 | 7.73 | 7.46 | 7.20 | 6.96 | 6.74 | 6.53 | 6.33 | 6.14 | 5.97 | 5.80 | 5.64 | 5.49 | 5.35 | 5.22 | 5.09 | 4.97 | 4.85 | 4.75 | 4.64 |      |      |      |      |      |
| 114 | 10.80 | 10.26 | 9.77  | 9.33 | 8.92 | 8.55 | 8.21 | 7.89 | 7.60 | 7.33 | 7.08 | 6.84 | 6.62 | 6.41 | 6.22 | 6.04 | 5.88 | 5.70 | 5.54 | 5.40 | 5.28 | 5.13 | 5.00 | 4.88 | 4.77 | 4.66 | 4.56 | 4.46 | 4.37 |      |      |      |
| 108 | 10.04 | 9.54  | 9.08  | 8.67 | 8.30 | 7.95 | 7.63 | 7.34 | 7.07 | 6.81 | 6.58 | 6.36 | 6.15 | 5.96 | 5.78 | 5.61 | 5.45 | 5.30 | 5.18 | 5.02 | 4.89 | 4.77 | 4.65 | 4.54 | 4.44 | 4.34 | 4.24 | 4.15 | 4.08 | 3.98 | 3.89 | 3.82 |
| 96  |       |       |       |      |      | 6.91 | 6.65 | 6.40 | 6.17 | 5.96 | 5.76 | 5.57 | 5.40 | 5.24 | 5.08 | 4.94 | 4.80 | 4.67 | 4.55 | 4.43 | 4.32 | 4.21 | 4.11 | 4.02 | 3.93 | 3.84 | 3.76 | 3.68 | 3.60 | 3.53 | 3.46 |      |
| 90  |       |       |       |      |      |      |      |      |      |      |      | 5.23 | 5.06 | 4.91 | 4.76 | 4.63 | 4.50 | 4.38 | 4.26 | 4.15 | 4.06 | 3.96 | 3.86 | 3.77 | 3.68 | 3.60 | 3.52 | 3.45 | 3.38 | 3.31 | 3.24 |      |

**FRONT INBOARD PIN OPTIONS****ROLL CENTRE ADJUSTMENT**

By adding or removing the Grey Suspension washers between the pivot blocks you are able to change the height of the roll centre.

**KICK UP OR ANTI-DIVE**

By adding the Grey Suspension washer at the front of the wishbone you will get anti-dive. 0.5mm = 0.5°

By adding the Grey Suspension washer at the rear of the wishbone you will get kick-up. 0.5mm = 0.5°

**REAR INBOARD PIN OPTIONS****ROLL CENTRE ADJUSTMENT**

By adding or removing the Grey Suspension washers between the pivot blocks you are able to change the height of the roll centre.

**SQUAT OR ANTI-SQUAT**

By adding the Grey Suspension washer at the rear of the wishbone you will get Anti-Squat. 0.5mm Difference = 0.5°

By adding the Grey Suspension washer at the front of the wishbone you will get Pro-Squat. 0.5mm Difference = 0.5°

**DIFF HEIGHT (HIGH OR LOW)****DIFF HEIGHT**

Diff height adjustment is provided so that the car may run level driveshafts at ride height with different diameter tyres.

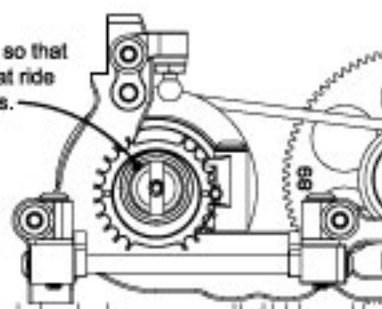
**FRONT AND REAR SUSPENSION LINK****(Roll Centre)****HEIGHT ADJUSTMENT**

The height of the inboard suspension link can be altered by adding or removing the violet spacer washers, between the link mount and the ball stud.

**WIDTH ADJUSTMENT**

The width of the inboard suspension link can be altered by adding or removing the Grey suspension washers, between the link mount and the Transmission housings.

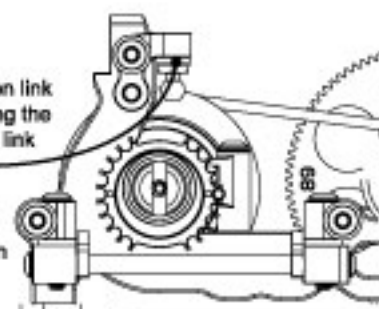

**ELECTRIC - TOURING CARS**

|      |                                       |
|------|---------------------------------------|
| K080 | Mi-3.5 Pro-CF - 1-10 4WD Trg 6 cell   |
| K081 | Mi-3.5 Pro-CF - 1-10 4WD Trg 5 Cell   |
| K082 | Mi-3.5 Race-S1 - 1-10 4WD Touring Car |

**CHASSIS PARTS**

|       |   |
|-------|---|
| U1042 | Aerial Mount - Universal                            |
| U119  | Aerial Tube - Pack 4                                |
| U2244 | Servo Mounts (pr)                                   |
| U2280 | SpeedFlex Rr Belt5mm - C3K                          |
| U2989 | Ball Grippa Sockets - (pk 8)                        |
| U3145 | CF Chassis - 2.0mm Kit - Mi-3                       |
| U3150 | CF Shock Bkt; Front - Mi-3 Kit                      |
| U3151 | CF Shock Bkt; Rear - Mi-3 Kit                       |
| U3154 | Foam Bumper - Mi-3                                  |
| U3155 | Front Bumper Mouldings - Mi-3                       |
| U3158 | Alloy Body Post Block; Horizontal Mount - Mi-3 (pr) |
| U3159 | Alloy Body Post Block; Vertical Mount - Mi-3 (pr)   |
| U3271 | CF LiPo Battery Locator (pr)                        |
| U3272 | CF 2008 Euro Chassis - 5 cell - Mi-3                |
| U3273 | CF 2008 Euro Top Deck - Mi-3                        |
| U3274 | CF 2008 Flex Top Deck - Mi-3                        |
| U3278 | Chassis; S1 6 cell - Mi-3.5                         |
| U3279 | Top deck; S1 - Mi-3.5                               |
| U3280 | Shock Bracket; Front S1 - Mi-3.5                    |
| U3281 | Shock Bracket; Rear S1 - Mi-3.5                     |
| U3282 | Steering Post Set - Mi-3.5 S1                       |
| U3283 | Instr Manual - Mi-3.5                               |

**BODYSHELLS & DECALS**

|            |  |
|------------|--|
| EC16283121 | East Coast - Body; 1x250 190mm               |
| EC16283122 | East Coast - Body; Euro-R 190mm              |
| EC16283123 | East Coast - Body; 320x1 190mm               |
| EC16283126 | East Coast - Body; Speed 6 190mm             |
| EC16283129 | East Coast - Body; Evo9x 190mm               |
| EC16283212 | East Coast - Body; Euro-R 200mm              |
| EC162832D6 | East Coast - Body; 350x2 190mm               |
| EC162832D8 | East Coast - Body; RX7 190mm                 |
| EC162832D9 | East Coast - Body; S15 190mm                 |
| EC38826B   | East Coast - Half Paint; Blue; Speed 6 190mm |
| EC38826R   | East Coast - Half Paint; Red; Speed 6 190mm  |
| U3167      | Decal Sheet - Mi-3 (pk3)                     |

**SUSPENSION**

|       |   |
|-------|---|
| U1430 | Tumbuckle Adjuster - 39mm (pr)            |
| U1440 | Pro Pin; grooved 1/8x25mm (pr)            |
| U2654 | Steering Yoke Pivot Set - 2 pairs         |
| U2718 | Pro Pin; Grooved 1/8x18mm (pr)            |
| U2722 | Ball Grippa Joints - U/S Stud 4prs        |
| U2736 | Steering Yoke; 2 degree - Mi-2 pr         |
| U2737 | Steering Yoke; Kit Std 4 degree - Mi-2 pr |
| U2738 | Steering Yoke; 6 degree - Mi-2 pr         |
| U2750 | Droop Screw; M5x8mm pk4                   |
| U2882 | Servo Saver Set; Light & Heavy Springs    |
| U2990 | Front Hub Carrier - Mi-2 E.C.             |
| U2991 | Purple Alloy Wheel Hex; Slim (pr)         |
| U2992 | Rear Hub Carrier - Mi-2 E.C./Mi-3         |
| U3127 | Wishbones; Graphite Front - Mi-3          |
| U3128 | Wishbones; Graphite Rear - Mi-3           |
| U3129 | Alloy Block; Screw - Mi-3 (pr)            |
| U3130 | Alloy Block; Pivot - Mi-3 (pr)            |
| U3133 | Alloy Top Link Mount - Mi-3 (pr)          |
| U3134 | Steering Post Set - Mi-3 CF               |
| U3135 | Centre Track Rods; Set 7 - Mi-3           |
| U3137 | Shock Mounting Post - Mi-3 (pr)           |
| U3142 | Pro Pivot Pin - 55mm - Mi-3 (pr)          |
| U3249 | Wishbones; Med Flex Front - Mi-3          |
| U3250 | Wishbones; Medium Flex Rear - Mi-3        |
| U3251 | Wishbones; Extra Flex Front - Mi-3        |
| U3252 | Wishbones; Extra Flex Rear - Mi-3         |
| U750  | Ball Grippa Joints-Short Stud 8prs        |
| U796  | Tumbuckle Adjuster - 24mm (pr)            |
| U797  | Tumbuckle Adjuster - 35mm (pr)            |
| U851  | Ball Grippa Joints - Long Stud 8prs       |

**TRANSMISSION**

|       |  |
|-------|--|
| U1895 | M3x8mm Button Screws & Washers pk4           |
| U1918 | Spare Blades                                 |
| U2573 | Pro-Diff Screw Set                           |
| U2721 | Rear Belt; Black Narrow - Mi-2               |
| U2733 | Diff Pulley Fences - Mi-2 & 3                |
| U2746 | CNC Diff Pulley - 4mm                        |
| U2761 | Diff Shims; 10 x 12                          |
| U2797 | CNC Spool Assy; Lightweight - Mi-2           |
| U2798 | CNC Spool Pulley - Mi-2                      |
| U3011 | Front Belt; 171t x 3.6mm                     |
| U3012 | Front Belt; Grey Stock 171t x 3.6mm          |
| U3013 | Rear Belt; Grey Stock - Mi-2 E.C.            |
| U3026 | Pivot; Pin & Screw; Alloy CV D/Shaft         |
| U3123 | Alloy Eccentric - Mi-3 (pr)                  |
| U3124 | Diff Retaining Post - Mi-3 (pr)              |
| U3125 | Layshaft Post - Mi-3                         |
| U3126 | CNC Pulley & Fences; 20T - Mi-3              |
| U3138 | Alloy Diff Output; Male - Mi-3               |
| U3139 | Alloy Diff Output; Female - Mi-3             |
| U3140 | Diff Washer; ProSpec - Mi-3 (pr)             |
| U3141 | HD Spool Output - Mi-3                       |
| U3160 | 85T 48DP CNC Spur Gear - Mi-3                |
| U3161 | 87T 48DP CNC Spur Gear - Mi-3                |
| U3162 | 89T 48DP CNC Spur Gear - Mi-3                |
| U3163 | 114T 64DP CNC Spur Gear - Mi-3               |
| U3164 | 116T 64dp CNC Spur Gear - Mi-3               |
| U3165 | 118T 64dp CNC Spur Gear - Mi-3               |
| U3170 | Pins & Shims; Axle - Mi-3 4pr                |
| U3223 | Diff; Fully Assembled Ceramic - Mi-3         |
| U3225 | CNC Spool Assembly HD - Mi-3                 |
| U3234 | Axle; Alloy CV Drive shaft 1pc               |
| U3247 | 70T 48DP CNC Spur Gear - Mi-3                |
| U3248 | 96T 64dp CNC Spur Gear - Mi-3                |
| U3256 | Alloy 7075 T6 Diff Mount; Front Left - Mi-3  |
| U3257 | Alloy 7075 T6 Diff Mount; Front Right - Mi-3 |
| U3258 | Alloy 7075 T6 Diff Mount; Rear Right - Mi-3  |
| U3259 | Alloy 7075 T6 Diff & Motor Mount - Mi-3      |
| U3260 | Ti Shock Post - Mi-3 pr                      |
| U3261 | Ti Droop Screw - Mi-3 pk4                    |
| U3262 | Ti Lay Post - Mi-3                           |
| U3267 | Driveshafts; Heavy Duty - Mi-3 (pr)          |
| U3269 | 90T 64DP CNC Spur Gear - Mi-3                |
| U3270 | 106T 64DP CNC Spur Gear - Mi-3               |
| U3275 | Bone; 7075 Alloy Driveshaft - Mi-3 1pc       |
| U3276 | Axle; HD Steel - Mi-3 1pc                    |
| U3400 | 66T 48DP CNC Spur Gear - Mi-3                |

**SHOCK ABSORBERS**

|       |   |
|-------|---|
| U2993 | Race Shock Body; Nickel Teflon (pr)         |
| U2994 | Race Shock Collar; threaded adjuster (pr)   |
| U2995 | Race Shock Piston - Trg 2 Hole (pr)         |
| U2996 | Race Shock Piston - Trg 3 Hole (kit std) pr |
| U2997 | Race Shock Rod; Ti-Nitride - 30mm (pr)      |
| U2998 | Race Shock Seal Housing; On Road (pr)       |
| U2999 | Race Shock Seal Rebuild Pack (pr)           |
| U3001 | Race Shocks; fully assembled pair           |
| U3284 | Race Shock Top Cap (pr) - Black Unversed    |
| U613  | Spring Stop & Spacer Mouldings (pr)         |

**SHOCK OIL**

|      |                                |
|------|--------------------------------|
| G030 | Pure Silicone Shock Oil - 30w  |
| G035 | Pure Silicone Shock Oil - 35w  |
| G040 | Pure Silicone Shock Oil - 40w  |
| G045 | Pure Silicone Shock Oil - 45w  |
| G050 | Pure Silicone Shock Oil - 50w  |
| G055 | Pure Silicone Shock Oil - 55w  |
| G060 | Pure Silicone Shock Oil - 60w  |
| G070 | Pure Silicone Shock Oil - 70w  |
| G080 | Pure Silicone Shock Oil - 80w  |
| G100 | Pure Silicone Shock Oil - 100w |

**SPRINGS**

|       |   |
|-------|---|
| U2822 | Spring Tuning Set - Pro-Touring (6 prs) |
| U2823 | Pro-Touring Springs - White 14lbs       |
| U2824 | Pro-Touring Springs - Blue 16lbs        |
| U2825 | Pro-Touring Springs - Green 18lbs       |
| U2826 | Pro-Touring Springs - Red 20lbs         |
| U2827 | Pro-Touring Springs - Yellow 23 lbs     |
| U2828 | Pro-Touring Springs - Violet 27 lbs     |

**BEARINGS & BALLS**

|       |   |
|-------|---|
| G200  | ZX1 - Microlube                         |
| H1031 | Bearing Blaster Aerosol 500ml           |
| U1301 | Silicone Diff Lube - Pot                |
| U1439 | Ball Bearing - 5 x 9 x 3 Non Fl. (pr)   |
| U1954 | Pro - Thrust Bearing                    |
| U1957 | Moly Axle Grease - Pot                  |
| U2148 | Ball Bearing - 5 x 10 x 4 Shielded (pr) |
| U2189 | Wheel Bearings 8pcs 10x5x4 Shim Set     |
| U2459 | Diff Balls; T/C 2.5mm pk12              |
| U2574 | Ball Bearing - 5 x 9 x 2.5 (pr)         |
| U2862 | Ceramic Bearing - 5x10x4 Shielded (pr)  |
| U3016 | Ball Bearing - 10x15x4 (pr)             |
| U3017 | Ceramic Bearing - 10x15x4 (pr)          |
| U3019 | Ceramic Nitride Diff Balls 2.5mm (pk12) |
| U3136 | Ball Bearing - 5 x 8 x 2.5 (pr)         |
| U3171 | Ceramic Bearing set - Mi-3              |

**SPEED PACKS**

|       |   |
|-------|---|
| CR035 | CORE RC - Serrated Alloy M4 Nuts; Blue pk 4   |
| CR036 | CORE RC - Serrated Alloy M4 Nuts; Purple pk 4 |
| H1010 | Body Clips - Fluorescent Yellow (pk10)        |
| H1011 | Body Clips - Fluorescent Green (pk10)         |
| H1012 | Body Clips - Fluorescent Red (pk10)           |
| H1013 | Body Clips - Metallic Red (pk10)              |
| H1014 | Body Clips - Metallic Blue (pk10)             |
| H1015 | Body Clips - Metallic Purple (pk10)           |
| U1547 | SPEED PACK - M3 Nuts                          |
| U1548 | SPEED PACK - M3 Washers                       |
| U1549 | SPEED PACK - M4 Nuts & Washers                |
| U1550 | SPEED PACK - Socket Wrenches (pk3)            |
| U1551 | SPEED PACK - E Clips 2x8pcs                   |
| U1552 | SPEED PACK - R Clips                          |
| U1606 | SPEED PACK - Servo Tape                       |
| U1633 | SPEED PACK - Small Pins (pk)                  |
| U1960 | SPEED PACK - O Rings; Various                 |
| U2128 | SPEED PACK - Grub-Set Screws M3 M4            |
| U2631 | SPEED PACK - Circlips Various 12 pcs          |
| U2760 | SPEED PACK - M3 Button Hd; 4 to 20            |
| U2858 | Alloy M3x6 Spacer Set; 0.5; 1; 2; 3mm - 16pcs |
| U2988 | M3 Csk Washers - Purple Alloy (pk10)          |
| U3002 | Wheel Spacer Washers (pk10)                   |
| U3021 | SPEED PACK - M3x6 Csk Allen Hi-T              |
| U3022 | SPEED PACK - M3x8 Csk Allen Hi-T              |
| U3023 | SPEED PACK - M3x10 Csk Allen Hi-T             |
| U3024 | SPEED PACK - M3x12 Csk Allen Hi-T             |
| U3131 | Alloy Spacers M3x7mm 0.5; 1; 2mm (pk18)       |
| U3168 | SPEED PACK - M2.5 Screws - pk 10              |

**TOOLS**

|            |                                     |
|------------|-------------------------------------|
| AT1142     | ATS Set Up Gauges - 1/10th Touring  |
| H1009      | Lexan Scissors; curved              |
| H1032      | Alloy Camber Gauge - 1/10th         |
| SPCF-MP001 | Carbon Fibre Pit Mat; Black 58x76cm |
| SPCF-SB001 | C/F Set Up Board; Silver 33x43cm    |
| U2789      | Schumacher Hex Driver - 1.5mm       |
| U2790      | Schumacher Hex Driver - 2.0mm       |
| U2791      | Schumacher Hex Driver - 2.5mm       |
| U2792      | Schumacher Hex Driver - 3.0mm       |
| U2795      | Schumacher M3 Nut Driver            |
| U2796      | Schumacher M4 Nut Driver            |
| U2818      | Schumacher Body Reamer              |

**ELECTRONICS**

|      |                               |
|------|-------------------------------|
| G837 | Mini Temp Gun - 420F 230C     |
| G848 | Tyre Warmers 1/10 Trg 7.2-12v |

**SPEEDCONTROLS**

|               |                                  |
|---------------|----------------------------------|
| SPEXT98801    | Speed Passion - BL ESC; GT 2.5T  |
| SPEXT98801LPF | Speed Passion - BL ESC; LFP 5.5T |

